

aprilia

SONIC 50



aprilia part# 8202339

use+maintenancebook



SAFETY WARNINGS

The following precautionary warnings are used throughout this manual in order to convey the following messages:

 **Safety warning. When you find this symbol on the vehicle or in the manual, be careful to the potential risk of personal injury. Non-compliance with the indications given in the messages preceded by this symbol may result in grave risks for your and other people's safety and for the vehicle!**

 **Indications to make the operations easier. Technical information.**

First edition: december 2002

Reprint:

Produced and printed by:
stp editing division
Soave (VERONA) - Italy
Tel. +39 - 045 76 11 911
Fax +39 - 045 76 12 241
E-mail: customer@stp.it
www.stp.it

On behalf of:
aprilia s.p.a.
via G. Galilei, 1 - 30033 Noale (VE) - Italy
Tel. +39 - 041 58 29 111
Fax +39 - 041 44 10 54
www.aprilia.com

TECHNICAL INFORMATION

★ The operations preceded by this symbol must be repeated also on the opposite side of the vehicle.

If not expressly indicated otherwise, for the reassembly of the units repeat the disassembly operations in reverse order.

The terms "right" and "left" are referred to the rider seated on the vehicle in the normal riding position.

WARNINGS - PRECAUTIONS - GENERAL ADVICE

Before starting the engine, carefully read this manual and in particular the section "SAFE DRIVE".

Your and other people's safety depends not only on your quickness of reflexes and on your agility, but also on what you know about the vehicle, on its efficiency and on your knowledge of the basic information for "SAFE DRIVE".

Therefore, get a thorough knowledge of the vehicle, in such a way as to be able to drive in the traffic safely.



This manual must be considered as an integral part of the vehicle and must always accompany it, even in case of resale.

aprilia has carried out this manual with the maximum attention, in order to supply the user with correct and updated information. However, since **aprilia** constantly improves the design of its products, there may be slight discrepancies between the characteristics of your vehicle and those described in this manual.

For any clarification concerning the information contained in this manual, do not hesitate to contact your **aprilia** Official Dealer.

For control and repair operations not expressly described in this publication, for the purchase of **aprilia** genuine spare parts, accessories and other products, as well as for specific advice, contact exclusively **aprilia** Official Dealers and Service Centers, which guarantee prompt and accurate assistance.

Thank you for choosing **aprilia**. We wish you a nice ride.

All rights as to electronic storage, reproduction and total or partial adaptation, with any means, are reserved for all Countries.



In some countries the antipollution and noise regulations in force require periodical inspections.

The user of the vehicle in these countries must:

- contact an **aprilia** Official Dealer to have the non-homologated components replaced with others homologated for use in the country in question;
- carry out the required periodical inspections.



Soon after purchasing the vehicle, write down the identification data indicated on the SPARE PARTS IDENTIFICATION LABEL in the table here below. The label is positioned on the right beam of the frame; to read it, remove the inspection cover, see p. 52 (REMOVING THE INSPECTION COVER).

aprilia		YEAR		Y	1	2	3	4	
SPARE PARTS IDENTIFICATION		I.M.		A	B	C	D	E	
I	UK	A	P	SF	B	D	F	E	GR
NL	CH	DK	J	SGP	SLO	IL	ROK	MAL	RCH
HR	AUS	USA	BR	RSA	NZ	CDN			

These data indicate:

- YEAR = year of manufacture (Y, 1, 2, ...);
- I.M. = modification code (A, B, C, ...);
- COUNTRY CODES = homologation country (I, UK, A, ...).

and are to be supplied to the **aprilia** Official Dealer as reference data for the purchase of spare parts or specific accessories of the model you have acquired.

In this manual the various versions are indicated by the following symbols:

- OPT** optional
- liquid-cooled version

VERSION:

- I** Italy
- UK** United Kingdom
- A** Austria
- P** Portugal
- SF** Finland
- B** Belgium
- D** Germany
- F** France
- E** Spain
- GR** Greece
- NL** Holland
- CH** Switzerland
- DK** Denmark
- J** Japan
- SGP** Singapore
- SLO** Slovenia
- IL** Israel
- ROK** South Korea
- MAL** Malaysia
- RCH** Chile
- HR** Croatia
- AUS** Australia
- USA** United States of America
- BR** Brazil
- RSA** South Africa
- NZ** New Zealand
- CDN** Canada

TABLE OF CONTENTS

SAFE DRIVE	5	STOPPING	33	SPARK PLUG	54
BASIC SAFETY RULES	6	PARKING	33	BATTERY	55
CLOTHING	9	POSITIONING THE VEHICLE		LONG INACTIVITY OF THE BATTERY	55
ACCESSORIES	10	ON THE STAND	34	CHECKING AND CLEANING	
LOAD	10	SUGGESTIONS TO PREVENT THEFT	34	THE TERMINALS	56
ARRANGEMENT OF THE MAIN ELEMENTS	12	MAINTENANCE	35	REMOVING THE BATTERY	56
ARRANGEMENT OF THE INSTRUMENTS	14	REGULAR SERVICE INTERVALS CHART	36	CHECKING	
INSTRUMENTS AND INDICATORS	14	IDENTIFICATION DATA	38	THE ELECTROLYTE LEVEL	57
INSTRUMENT AND INDICATOR TABLE	15	AIR CLEANER	38	RECHARGING THE BATTERY	57
MAIN INDEPENDENT CONTROLS	16	CHECKING		INSTALLING THE BATTERY	57
CONTROLS ON THE LEFT SIDE		THE TRANSMISSION OIL LEVEL	40	CHANGING THE FUSE	58
OF THE HANDLEBAR	16	CHANGING		ADJUSTING	
CONTROLS ON THE RIGHT SIDE		THE TRANSMISSION OIL	41	THE VERTICAL HEADLIGHT BEAM	59
OF THE HANDLEBAR	17	FRONT WHEEL	42	BULBS	59
IGNITION SWITCH	18	REAR WHEEL	44	CHANGING THE HEADLIGHT BULBS	60
STEERING LOCK	18	CHECKING		CHANGING THE FRONT	
AUXILIARY EQUIPMENT	19	THE BRAKE PAD WEAR	45	DIRECTION INDICATOR BULBS	61
UNLOCKING/LOCKING THE SADDLE	19	CHECKING		CHANGING THE DASHBOARD BULBS	62
CRASH HELMET / GLOVE COMPARTMENT ..	19	THE SHOE WEAR	46	CHANGING THE REAR LIGHT BULB	63
ANTI-THEFT HOOK	19	GREASING		CHANGING THE NUMBER PLATE BULB	63
TOOL KIT	20	THE REAR BRAKE CAM PIN	46	TRANSPORT	64
BAG HOOK	20	CHECKING THE STEERING	48	DRAINING THE FUEL TANK	64
GLOVE COMPARTMENT	20	CHECKING		CLEANING	65
MAIN COMPONENTS	21	THE ENGINE FULCRUM AXIS	48	LONG PERIODS OF INACTIVITY	66
FUEL	21	REMOVING		AFTER A PERIOD OF INACTIVITY	66
2 STROKE OIL TANK	22	THE EXHAUST SILENCER	49	TECHNICAL DATA	67
BRAKE FLUID - recommendations	22	REMOVING		LUBRICANT CHART	71
FRONT BRAKE DISC	23	THE FRONT HANDLEBAR COVER	50	Importers	74-75
REAR DRUM BRAKE	24	REMOVING		WIRING DIAGRAM Sonic 50	76
TYRES	25	THE REAR HANDLEBAR COVER	50	WIRING DIAGRAM KEY Sonic 50	77
COOLANT 	26	REMOVING			
AUTOMATIC		THE FRONT TRANSPARENT SCREEN	51		
LIGHT SWITCHING VERSION	28	REMOVING			
CATALYTIC SILENCER	28	THE REAR-VIEW MIRROR	51		
INSTRUCTIONS FOR USE	29	REMOVING			
PRELIMINARY CHECKING OPERATIONS	29	THE INSPECTION COVER	52		
STARTING	30	REMOVING THE FRONT COVER			
DEPARTURE AND DRIVE	32	OF THE REAR PART OF THE FAIRING	52		
RUNNING-IN	33	IDLING ADJUSTMENT	53		
		ADJUSTING			
		THE ACCELERATOR CONTROL	53		

aprilia



safe drive

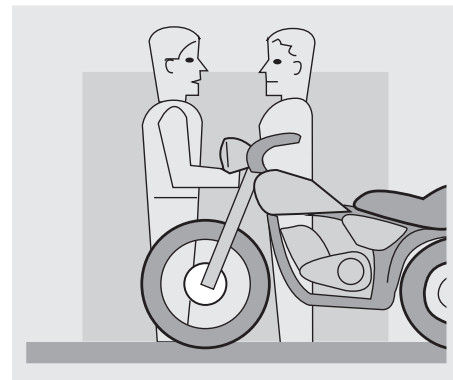
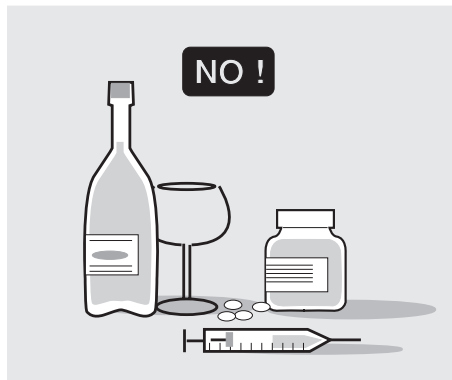

BASIC SAFETY RULES

To drive the vehicle it is necessary to be in possession of all the requirements prescribed by law (driving licence, minimum age, psychophysical ability, insurance, state taxes, vehicle registration, number plate, etc.).

Gradually get to know the vehicle by driving it first in areas with low traffic and/or private areas.

The use of medicines, alcohol and drugs or psychotropic substances notably increases the risk of accidents.

Be sure that you are in good psychophysical conditions and fit for driving and pay particular attention to physical weariness and drowsiness.

Most road accidents are caused by the driver's lack of experience.

NEVER lend the vehicle to beginners and, in any case, make sure that the driver has all the requirements for driving.

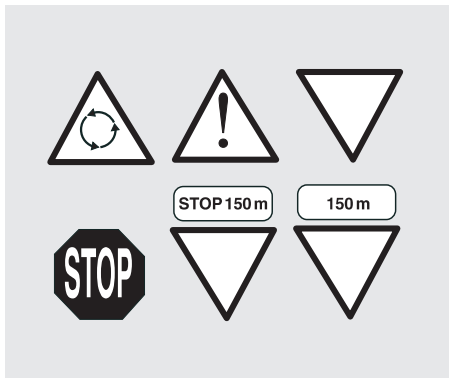

Rigorously observe all road signs and national and local road regulations.

Avoid abrupt movements that can be dangerous for yourself and other people (for example: rearing up on the back wheel, speeding, etc.), and give due consideration to the road surface, visibility and other driving conditions.

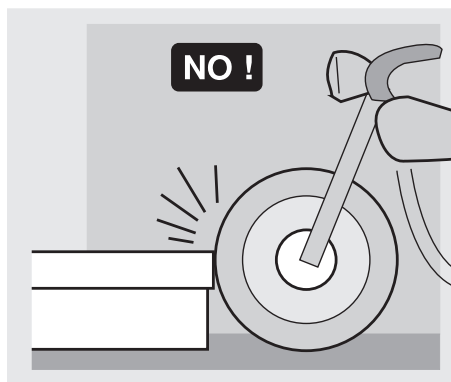

Avoid obstacles that could damage the vehicle or make you lose control.

Avoid riding in the slipstream created by preceding vehicles in order to increase your speed.

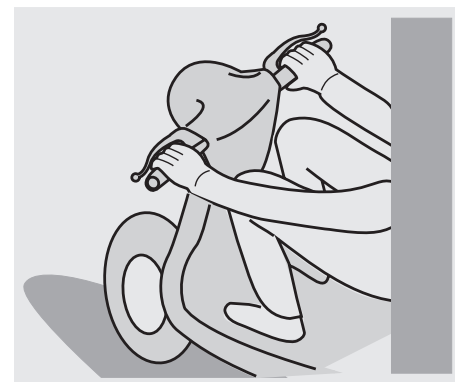

Always drive with both hands on the handlebars and both feet on the footrests, in the correct driving posture.

Avoid standing up or stretching your limbs while driving.

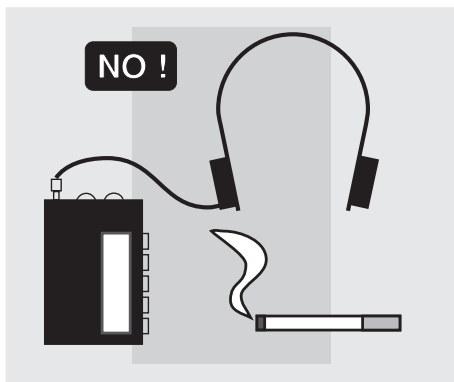

The driver should pay attention and avoid distractions caused by people, things and movements (never smoke, eat, drink, read, etc.) while driving.

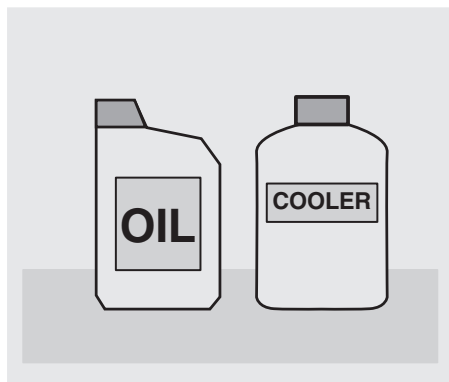

Use only the vehicle's specific fuels and lubricants (indicated in the "LUBRICANT CHART"); check all oil, fuel and coolant levels regularly.

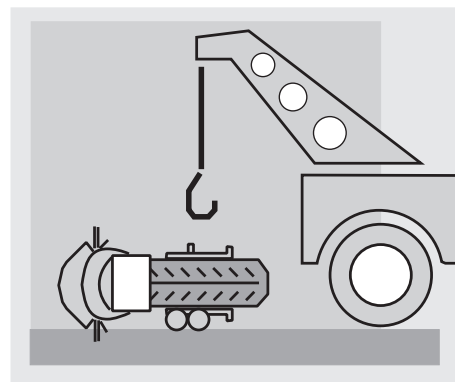

If the vehicle has been involved in an accident, make sure that no damage has occurred to the control levers, pipes, wires, braking system and vital parts.

If necessary, have the vehicle inspected by an **aprilia** Official Dealer, who should carefully check the frame, handlebars, suspensions, safety parts and all the devices that you cannot check by yourself.

Always remember to report any malfunction to the technicians to help them in their work.

Never use the vehicle when the amount of damage it has suffered endangers your safety.

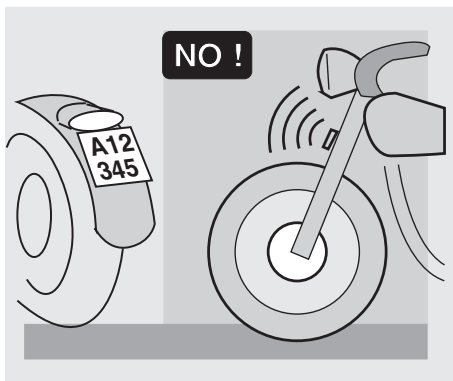

Never change the position, inclination or colour of: number plate, direction indicators, lights and horns.

Any modification of the vehicle will result in the invalidity of the guarantee.

Any modification of the engine or of other members which is aimed at increasing the speed or the power of the vehicle is prohibited by the law; in fact, any modification resulting in an increase of the maximum speed or of the engine displacement would change the scooter into a motorcycle, which implies the following obligations for the owner:

- new homologation;
- new registration;
- appropriate driving license.

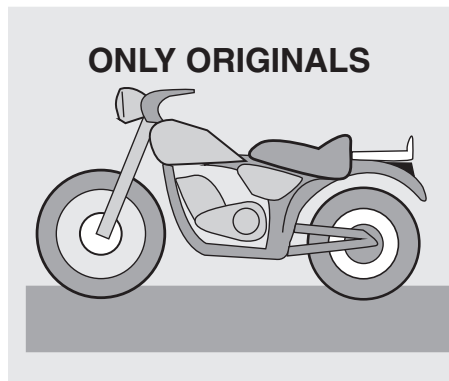

Further, said modifications cause the loss of the insurance cover, since insurance policies expressly prohibit to make technical changes aimed at increasing the vehicle performance levels.

For the reasons stated above, the failure to comply with the tampering prohibition is punished by law with apposite sanctions (including the confiscation of the vehicle), which, according to the case, can be combined with the sanctions provided for not using the crash helmet and/or the number plate, for the violation of fiscal obligations (ownership tax) and with penal sanctions provided for using the vehicle without driving license.

Never race with other vehicles.

Avoid off-road driving.

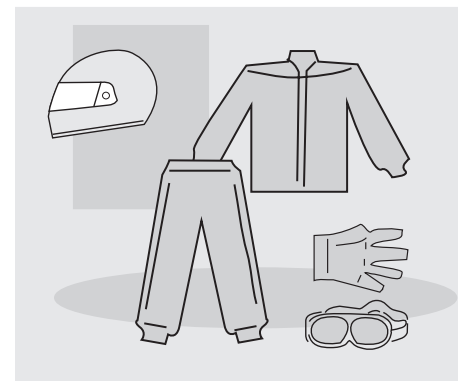

CLOTHING

Before starting, always wear a correctly fastened crash helmet. Make sure that it is homologated, in good shape, of the right size and that the visor is clean.

Wear protective clothing, preferably in light and/or reflecting colours. In this way you will make yourself more visible to the other drivers, thus notably reducing the risk of being knocked down, and you will be more protected in case of fall. This clothing should be very tight-fitting and fastened at the wrists and ankles. Strings, belts and ties should not be hanging loose; prevent these and other objects from interfering with driving by getting entangled with moving parts or driving mechanisms.

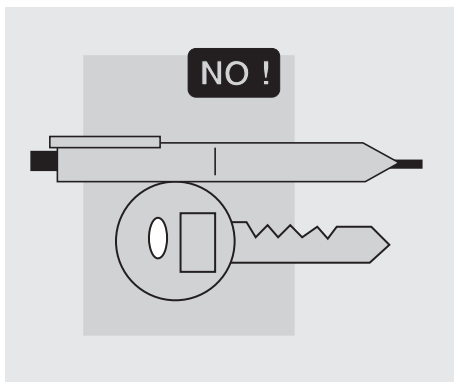

Do not keep objects that can be dangerous in case of fall, for example pointed objects like keys, pens, glass vials etc. in your pockets (the same recommendations also apply to passengers).

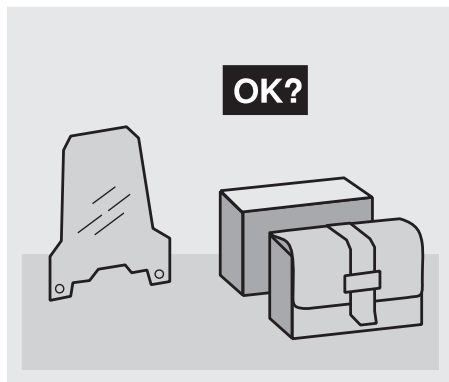

ACCESSORIES

The owner of the vehicle is responsible for the choice, installation and use of any accessory.

Avoid installing accessories that cover horns or lights or that could impair their functions, limit the suspension stroke and the steering angle, hamper the operation of the controls and reduce the distance from the ground and the angle of inclination in turns. Avoid using accessories that hamper access to the controls, since this can prolong reaction times during an emergency. Large fairings and windscreens assembled on the vehicle can produce aerodynamic forces capable of compromising the stability of the vehicle while driving. Make sure that the equipment is well fastened to the vehicle and not dangerous during driving.

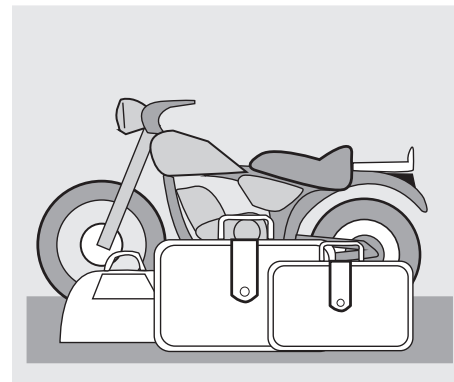

Do not install electrical devices and do not modify those already existing to avoid electrical overloads, because the vehicle could suddenly stop or there could be a dangerous current shortage in the horn and in the lights. **aprilia** recommends the use of “**aprilia** genuine accessories”.

LOAD

Be careful and moderate when loading your luggage. Keep any luggage loaded as close as possible to the centre of the vehicle and distribute the load uniformly on both sides, in order to reduce imbalance to the minimum. Furthermore, make sure that the load is firmly secured to the vehicle, especially during long trips.

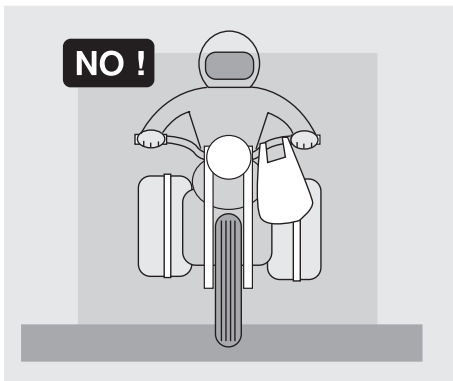

Avoid hanging bulky, heavy and/or dangerous objects on the handlebars, mudguards and forks, because the vehicle might respond more slowly in turns and its manoeuvrability could be unavoidably impaired.

Do not place bags that are too bulky on the vehicle sides, because it could hit people or obstacles making you lose control of the vehicle.

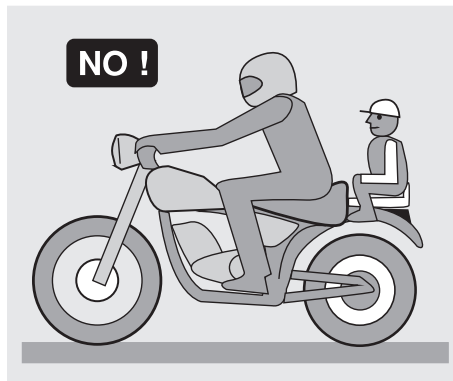

Do not carry any bag if it is not tightly secured to the vehicle.

Do not carry bags which protrude too much from the luggage-rack or which cover the lights, horn or indicators.

Do not carry animals or children on the glove compartment or on the luggage-rack.

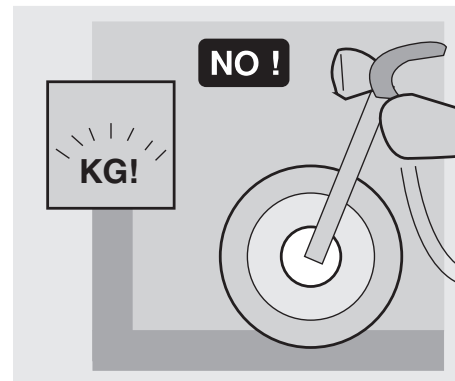

Do not exceed the maximum load allowed for each side-bag.

When the vehicle is overloaded, its stability and its manoeuvrability can be compromised.

ARRANGEMENT OF THE MAIN ELEMENTS

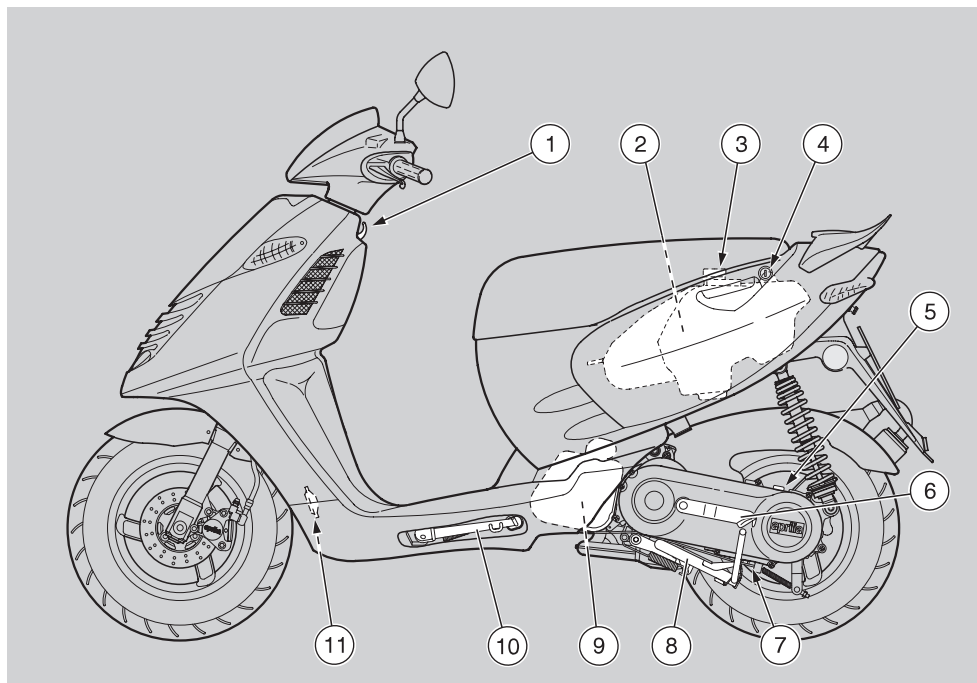

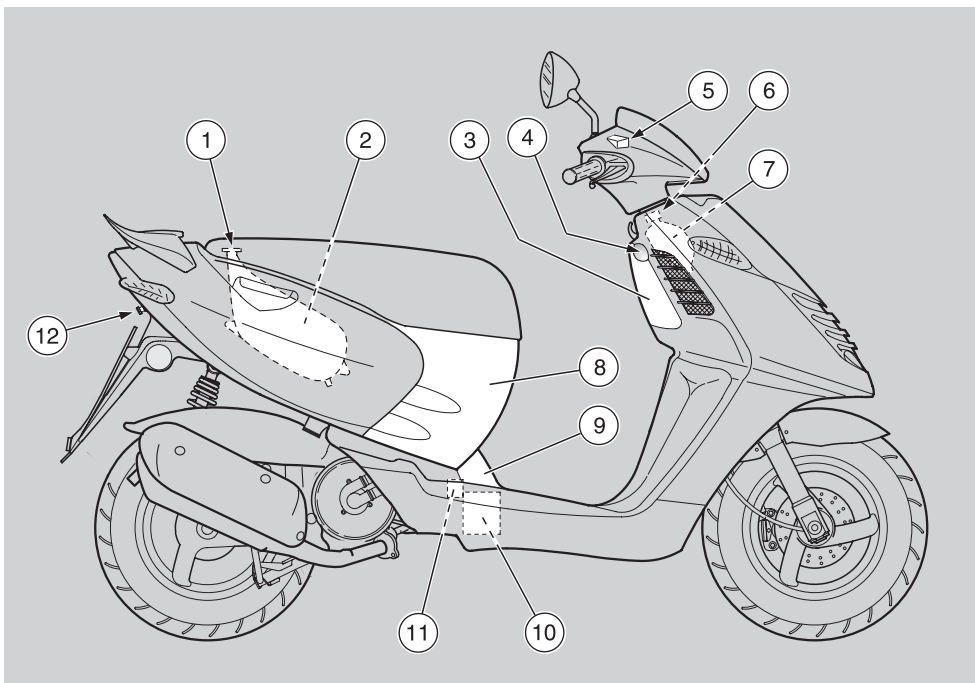

KEY

- | | |
|---------------------------------|--------------------------------|
| 1) Bag hook | 7) Transmission oil drain plug |
| 2) Fuel tank | 8) Centre stand |
| 3) Fuel tank plug | 9) Air cleaner |
| 4) Saddle lock | 10) Side stand OPT |
| 5) Transmission oil filling cap | 11) Horn |
| 6) Kick starter | |



KEY

- | | |
|---|---|
| 1) 2 stroke oil tank plug | 8) Front cover of the rear part of the fairing |
| 2) 2 stroke oil tank | 9) Inspection cover |
| 3) Glove compartment | 10) Battery |
| 4) Ignition switch/steering lock | 11) Fuse carrier |
| 5) Brake fluid reservoir (front brake) | 12) Anti-theft hook (for the aprilia "Body-Guard" armored cable OPTI). |
| 6) Coolant expansion tank plug  | |
| 7) Expansion tank  | |

ARRANGEMENT OF THE INSTRUMENTS

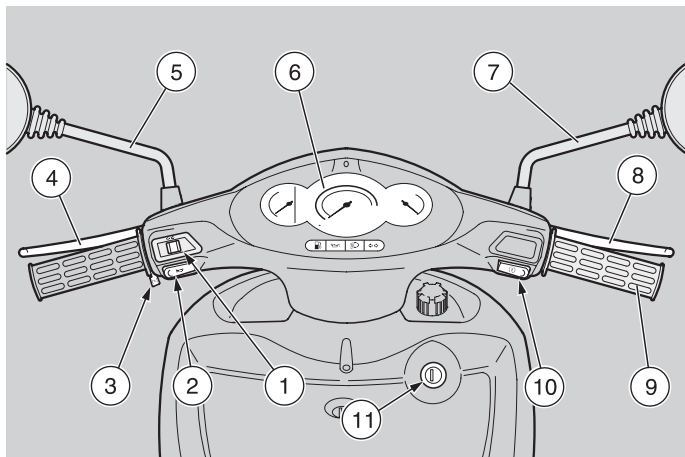

KEY

- 1) Direction indicator switch (↔↔)
- 2) Horn push button (🔊)
- 3) Cold start lever (L/L)
- 4) Rear brake lever
- 5) Left rear-view mirror (not provided in the **UK** version)
- 6) Instruments and indicators
- 7) Right rear-view mirror (in the countries where required)
- 8) Front brake lever
- 9) Throttle grip
- 10) Start push button (🔌)
- 11) Ignition switch/steering lock (🔑 - 🔒 - 🔓)

INSTRUMENTS AND INDICATORS

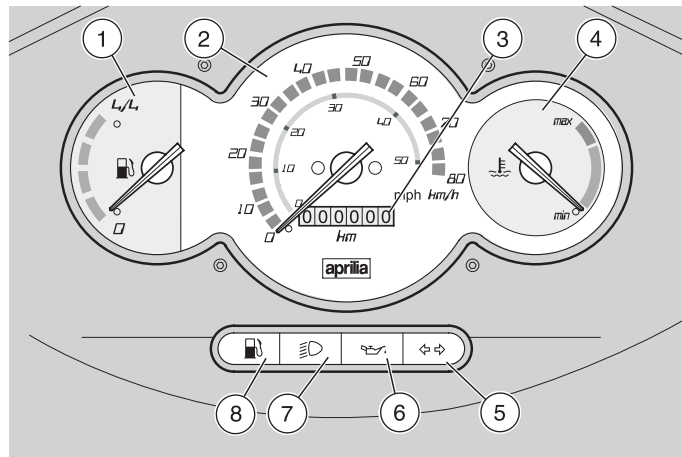

KEY

- 1) Fuel level indicator (🛢️)
- 2) Speedometer
- 3) Total kilometres odometer
- 4) Coolant temperature indicator (🌡️) (🌀)
- 5) Green direction indicator warning light (↔↔)
- 6) Red 2 stroke oil reserve warning light (🛢️)
- 7) Green low beam warning light (🔦)
- 8) Amber low fuel warning light (🛢️)

INSTRUMENT AND INDICATOR TABLE

Description	Function
Direction indicator warning light (↔)	It blinks when the direction indicators are on.
2 stroke oil reserve warning light (⚠)	<p>It comes on when the ignition switch is in position “○” and the start push button “⊕” is pressed, thus checking the proper functioning of the bulb. If the light does not come on during the starting, provide for replacing the bulb.</p> <p>⚠ If the warning light comes on and does not go out after the start push button “⊕” has been released, or if it comes on during normal functioning, this means that the 2 stroke oil reserve is being used; in this case, top up the 2 stroke oil tank, see p. 22 (2 STROKE OIL TANK).</p>
Total kilometres odometer	It indicates the total number of kilometres covered.
Speedometer	It indicates the driving speed.
Low beam warning light (⊕)	It comes on whenever the ignition switch is turned to position “○”.
Low fuel warning light (⛽)	It comes on when the quantity of fuel left in the tank is about 1,5 ℓ.
Fuel level indicator (⛽)	It indicates the approximate fuel level in the tank.
Coolant temperature indicator (⚠)	<p>It indicates the approximate temperature of the coolant in the engine. When the pointer starts moving beyond the “min” level, the temperature is sufficient for driving the vehicle. The normal running temperature range is indicated by the central area of the scale. If the pointer reaches the red area, stop the engine and check the coolant level, see p. 26 (COOLANT ⚠).</p> <p>⚠ If the maximum allowed temperature is exceeded (red area “max” of the scale), the engine may be seriously damaged.</p>

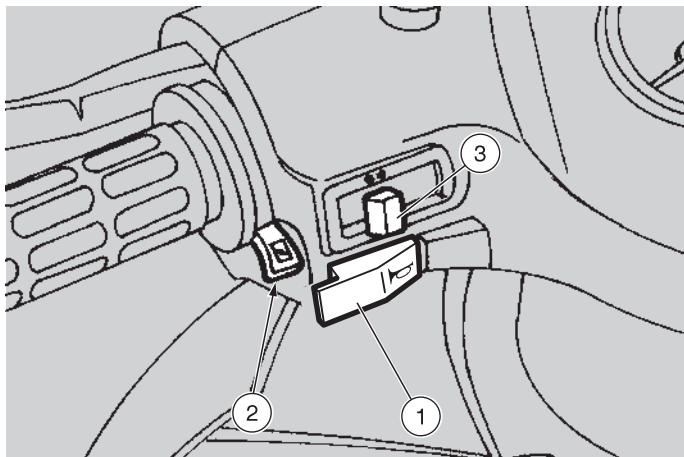

CONTROLS ON THE LEFT SIDE OF THE HANDLEBAR

 The electrical parts work only when the ignition switch is in position “O”.

 The lighting system works only when the engine is running.

1) HORN PUSH BUTTON (🔊)

The horn is activated when the push button is pressed.

2) COLD START LEVER (↴)

The starter for the cold start of the engine is operated by rotating the lever downwards.

To disconnect the cold start, bring the lever to its initial position.

3) DIRECTION INDICATOR SWITCH (↵↶)

To indicate the turn to the left, move the switch to the left; to indicate the turn to the right, move the switch to the right.

To turn off the direction indicator, press the switch.

CONTROLS ON THE RIGHT SIDE OF THE HANDLEBAR

 The electrical parts work only when the ignition switch is in position “O”.

 The lighting system works only when the engine is running.

1) START PUSH BUTTON (Ⓢ)

When the start push button is pressed and one of the brake levers (front or rear) is activated at the same time, the starter makes the engine run.

For the starting procedure, see p. 30 (STARTING).

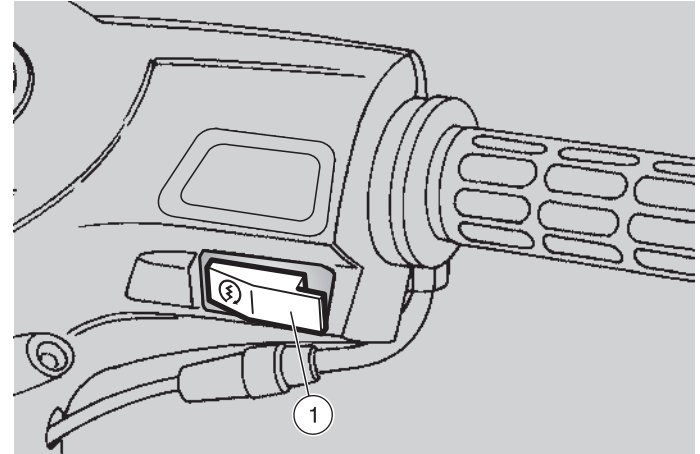

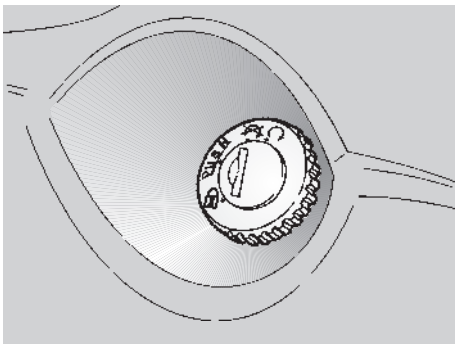



IGNITION SWITCH

The ignition switch is positioned on the right side, near the steering column.

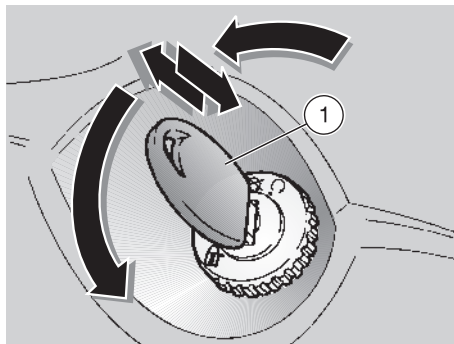
 **The key (1) operates the ignition switch/steering lock, glove compartment and the saddle lock. Two keys are supplied together with the vehicle (one spare key).**





STEERING LOCK

Never turn the key to position “” in running conditions, in order to avoid losing control of the vehicle.

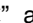

OPERATION

To lock the steering:

- ◆ Turn the handlebar completely leftwards.
- ◆ Turn the key (1) to position “” and press it.
- ◆ Release the key.

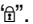
 **Turn the key and steer the handlebar at the same time.**

- ◆ Rotate the key (1) anticlockwise (leftwards), steer the handlebar slowly until the key (1) reaches position “”.
- ◆ Extract the key.

Position	Function	Key removal
 Steering lock	The steering is locked. It is neither possible to start the engine, nor to switch on the lights.	It is possible to remove the key.
	Neither the engine, nor the lights can be switched on.	It is possible to remove the key.
	The engine and the lights can be switched on.	It is not possible to remove the key.

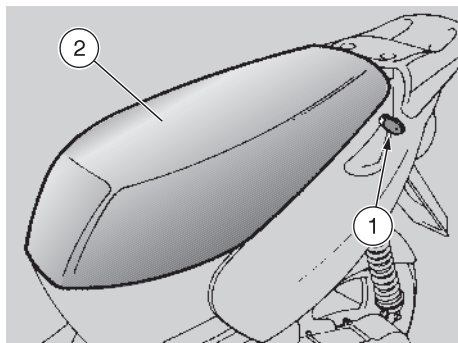

UNLOCKING/LOCKING THE SADDLE

To unlock and lift the saddle:

- ◆ Insert the key in the saddle lock (1).
- ◆ Turn the key clockwise and raise the saddle (2).

 **Before lowering and locking the saddle, make sure that you have not left the key in the crash helmet/glove compartment.**

- ◆ To lock the saddle, lower and press it (without exerting too much pressure), thus making the lock snap shut.



Before leaving, make sure that the saddle is properly locked.

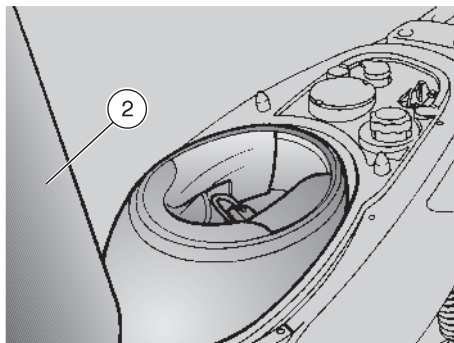

CRASH HELMET / GLOVE COMPARTMENT

Thanks to the crash helmet/glove compartment, you no longer have to carry the crash helmet or other objects with you every time you park the vehicle.

The compartment is positioned under the saddle.

To reach it:

- ◆ Raise the saddle, see beside (UNLOCKING/LOCKING THE SADDLE).

 **Position the helmet with the opening facing upwards, as shown in the figure.**



Do not load the crash helmet/glove compartment too much.

Maximum allowed weight: 2.5 kg.

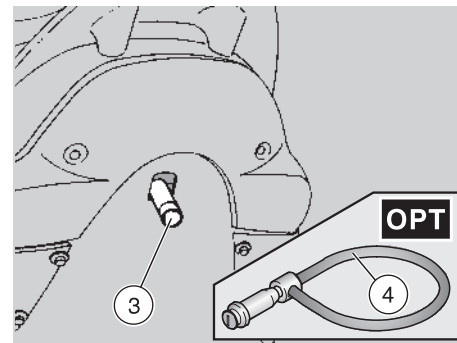

ANTI-THEFT HOOK

The anti-theft hook (3) is positioned on the rear side of the vehicle, near the rear light.

To prevent the vehicle from being stolen, it is advisable to secure it with the **aprilia** "Body-Guard" armored cable **OPT** (4), available at any **aprilia** Official Dealer.



Do not use the hook to lift the vehicle or for any purpose other than securing the vehicle once it has been parked.

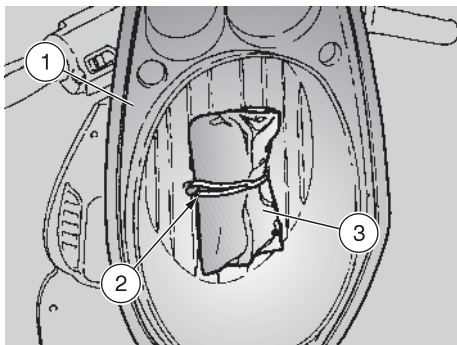

TOOL KIT

The tool kit is hooked to the underside of the saddle.

To reach it, proceed as follows:

- ◆ Lift the saddle (1), see p. 19 (UNLOCKING/LOCKING THE SADDLE).
- ◆ Release the rubber band (2) from the hook.
- ◆ Take the tool kit (3).

The tool kit (3) includes:

- n. 1 tool case
- n. 1 21 mm spark plug socket spanner
- n. 1 socket spanner rod
- n. 1 8/10 mm socket spanner
- n. 1 double-ended, cross-/cut headed-screwdriver type PH size 2
- n. 1 screwdriver handle
- n. 1 3 mm hexagon spanner
- n. 1 4 mm hexagon spanner

Maximum allowed weight: 1.5 kg.

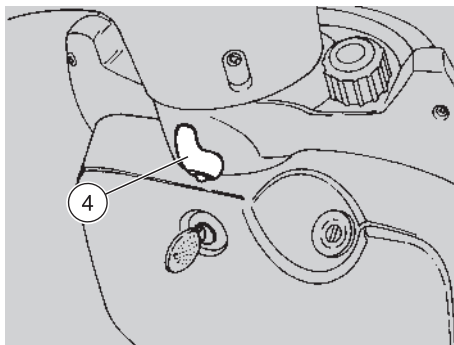

BAG HOOK



Do not hang excessively bulky bags or parcels to the hook, as this may seriously compromise the manoeuvrability of the vehicle or the movement of your feet.

The bag hook (4) is positioned on the front part of the inner shield.

Max. allowed weight: 1.5 kg.

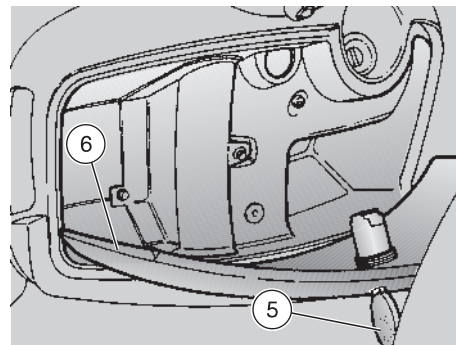

GLOVE COMPARTMENT

It is placed under the handlebar, on the inner part of the shield.

To reach it:

- ◆ Introduce the ignition key (5) in the lock.
- ◆ Turn the key clockwise, pull it and open the door (6).



Before locking the door, make sure that you have not left the key in the glove compartment.

To lock the door (6), raise and press it. It is not necessary to use the key.

Maximum allowed weight: 1.5 kg.



FUEL



The fuel used for internal combustion engines is extremely inflammable and in particular conditions it can become explosive.

It is important to carry out the refuelling and the maintenance operations in a well-ventilated area, with the engine off.

Do not smoke while refuelling or near fuel vapours, in any case avoid any contact with naked flames, sparks and any other heat source to prevent the fuel from catching fire or from exploding.

Further, prevent fuel from flowing out of the fuel filler, as it could catch fire when getting in contact with the red-hot surfaces of the engine.

In case some fuel has accidentally been spilled, make sure that the area has completely dried and before starting the vehicle verify that there is no fuel inside the fuel filler neck.

Since petrol expands under the heat of the sun and due to the effects of sun radiation, never fill the tank to the brim.

Screw the plug (1) up carefully after refuelling.

Avoid any contact of the fuel with the skin and the inhalation of vapours; do not swallow fuel or pour it from a receptacle into another by means of a tube.

KEEP AWAY FROM CHILDREN.

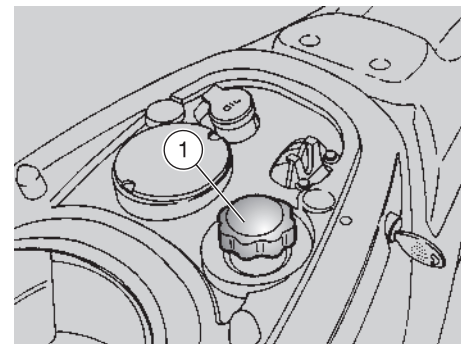

Use only unleaded petrol, in conformity with the DIN 51607 standard, min. O.N. 95 (N.O.R.M.) and 85 (N.O.M.M.).

FUEL TANK CAPACITY
(reserve included): 8 ℓ

TANK RESERVE: 1.5 ℓ

To refuel, proceed as follows:

- ◆ Lift the saddle, see p. 19 (UNLOCKING/LOCKING THE SADDLE).
- ◆ Unscrew and remove the fuel tank plug (1).
- ◆ Refuel.

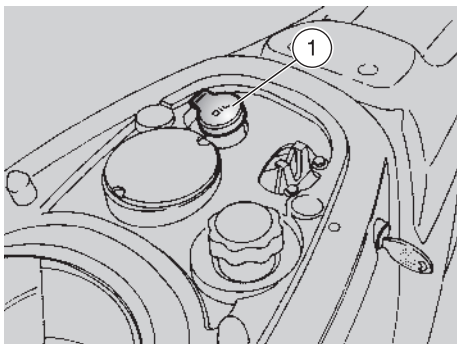

This operation is indispensable, since the operation of the engine with air in the mixer oil system may cause serious damages to the engine itself.

To top up the 2 stroke oil tank, proceed as follows:

- ◆ Lift the saddle, see p. 19 (UNLOCKING/LOCKING THE SADDLE).
- ◆ Remove the plug (1).

2 STROKE OIL TANK CAPACITY: 1.6 ℓ

TANK RESERVE: 0.5 ℓ



Wash your hands carefully after using the oil.

Do not dispose of the oil in the environment.

KEEP AWAY FROM CHILDREN.

BRAKE FLUID - recommendations



Sudden resistance or clearance problems on the brake lever may be due to problems in the hydraulic system.

For any doubt regarding the perfect functioning of the braking system and in case you are not able to carry out the usual checking operations, contact your **aprilia** Official Dealer.

Make sure that the brake disc and the friction elements are neither oily nor greasy, especially after maintenance or checking operations.

Check that the brake cable is neither twisted nor worn out.

Prevent water or dust from accidentally getting into the circuit.

In case maintenance operations are to be performed on the hydraulic circuit, it is advisable to use latex gloves.

If the brake fluid gets in contact with the skin or the eyes, it can cause serious irritations.

Carefully wash the parts of your body that get in contact with the liquid. Consult a doctor or an oculist if the liquid gets in contact with your eyes.

Do not dispose of the brake fluid in the environment.

KEEP AWAY FROM CHILDREN.



When using the brake fluid, take care not to spill it on the plastic or painted parts, since it irreparably damages them.

2 STROKE OIL TANK

Top up the 2 stroke oil tank every 500 km.

The vehicle is provided with a separate mixer that makes it possible to mix petrol with oil for the lubrication of the engine, see p. 71 (LUBRICANT CHART).

The reserve is indicated by the coming on of the 2 stroke oil reserve warning light “سعة” positioned on the dashboard, see p. 14 and 15 (INSTRUMENTS AND INDICATORS).



The use of the vehicle without 2 stroke oil causes serious damages to the engine.

If you run out of oil in the 2 stroke oil tank or if the mixer oil pipe has been removed, it is necessary to contact an **aprilia** Official Dealer, who will provide for bleeding the system.

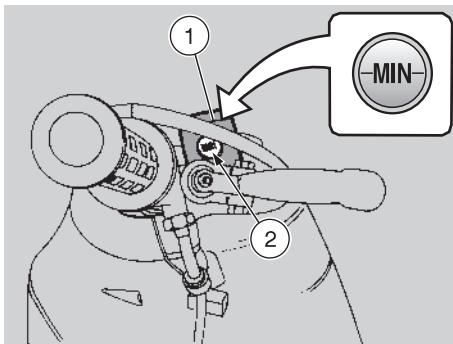

FRONT BRAKE DISC

⚠ The brakes are the parts that most ensure your safety and for this reason they must always be perfectly working. The brake fluid must be changed once a year by an **aprilia** Official Dealer.

This vehicle is provided with front hydraulic disc brake.

When the disc pads wear out, the level of the fluid decreases to automatically compensate for their wear.

The brake fluid reservoir (1) is positioned near the front brake lever coupling. Periodically check the brake fluid level in the reservoir (1) and the pad wear, see p. 45 (CHECKING THE BRAKE PAD WEAR).

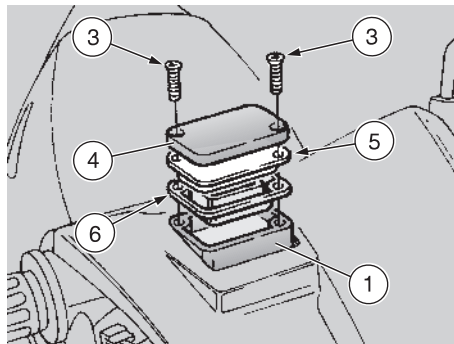

CHECKING

To check the brake fluid level, proceed as follows:

- ◆ Position the vehicle on the centre stand.
- ◆ Rotate the handlebar leftwards, so that the fluid contained in the reservoir is parallel to the “MIN” mark stamped on the glass (2).
- ◆ Make sure that the level of the brake fluid contained in the tank exceeds the “MIN” mark stamped on the glass (2).
- ◆ If not, provide for topping up.

TOPPING UP

Carefully read p. 22 (BRAKE FLUID - recommendations).

⚠ The brake fluid may flow out of the reservoir. Do not operate the brake lever if the screws (3) are loose or, most important, if the brake fluid tank cover has been removed.

- ◆ Unscrew the two screws (3).
- ◆ Remove the cover (4).
- ◆ Remove the guide cover (5).

⚠ In order not to spill the brake fluid while topping up, keep the fluid in the reservoir parallel to the reservoir rim.

- ◆ Remove the gasket (6).

☞ In order to reach the “MAX” level, top up until covering the glass (2) completely, with the brake fluid reservoir rim parallel to the ground.

⚠ The topping up to the “MAX” level can be carried out only with new pads.

The fluid level decreases progressively with the pad wear.

Do not top up to the “MAX” level with worn pads, since this may cause an out-flow of liquid when the brake pads are changed.

- ◆ Fill the tank with brake fluid, see p. 71 (LUBRICANT CHART), until it covers the glass completely.
- ◆ Put back the gasket (6) in its seat correctly.
- ◆ Put back the guide cover (5) correctly.
- ◆ Put back the cover (4).
- ◆ Screw and tighten the two screws (3).

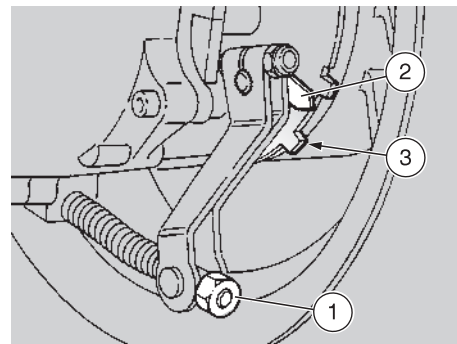
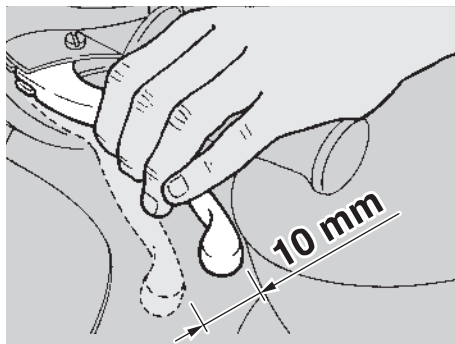

Check the braking efficiency. If necessary, contact your **aprilia** Official Dealer.

In case of excessive movement of the brake lever, of excessive elasticity or in case there is air in the circuit, contact your **aprilia** Official Dealer, since it may be necessary to bleed the system.

REAR DRUM BRAKE



The brakes are the parts that most ensure your safety and for this reason they must always be perfectly working.

For any doubt regarding the perfect functioning of the braking system and in case you are not able to carry out the usual checking operations, contact your **aprilia** Official Dealer.

ADJUSTING THE BRAKE

- ◆ Measure the distance covered by the lever before the brake starts its braking action. The idle stroke at the end of the brake lever must be about 10 mm.
- ◆ Adjust the clearance by acting on the adjuster (1).
- ◆ Put on the brake repeatedly and make sure that the wheel turns freely after the brake has been released.
- ◆ Check the braking efficiency.

The fact that the adjuster (1) can be tightened completely or the indicator (2) is positioned beyond the reference tooth (3) indicates that the brake shoes are worn; in this case, see p. 46 (CHECKING THE SHOE WEAR).



TYRES

This vehicle is provided with tyres with inner tube.



Periodically check the tyre inflation pressure at room temperature.

If the tyres are hot, the measurement is not correct.

Carry out the measurement especially after long rides.

If the inflation pressure is too high, the ground unevenness cannot be dampened and is therefore transmitted to the handlebar, thus compromising the driving comfort and reducing the road holding during turns.

If, on the contrary, the inflation pressure is too low, the tyre sides are under greater stress and the tyre itself may slip on the rim or it may become loose, with consequent loss of control of the vehicle.

In case of sudden braking the tyres could even get out of the rims. Further, the vehicle could skid while turning.

Check the surface and the wear of the tyres, since tyres in bad conditions can impair both the grip and the controllability of the vehicle.

Change the tyre when it is worn out or in case of puncture on the tread side, if the puncture is larger than 5 mm.

Use only tyres in the size suggested by **aprilia**, see p. 67 (TECHNICAL DATA).

Do not install tyres with air tube on rims for tubeless tyres and viceversa.

Make sure that the tyres always have their valve sealing caps on, to prevent them from suddenly going flat.

Change, reparation, maintenance and balancing operations are very important and should be carried out by qualified technicians with appropriate tools.

For this reason, it is advisable to have the above mentioned operations carried out by an **aprilia** Official Dealer or by a qualified tyre repairer.



If the tyres are new, they may still be covered with a slippery film: drive carefully for the first miles.

Do not oil the tyres with unsuitable fluids.

INFLATION PRESSURE

SOLO RIDER

front: 170 kPa (1.7 bar)
rear: 190 kPa (1.9 bar)

RIDER AND ONE PASSENGER

(in the countries where this is allowed)
front: 170 kPa (1.7 bar)
rear: 210 kPa (2.1 bar)

MINIMUM TREAD DEPTH LIMIT

front: 1.5 mm
rear: 1.5 mm



The coolant is made up of 50% water and 50% antifreeze.

This mixture is ideal for most running temperatures and ensures good protection against corrosion.

It is advisable to keep the same mixture also in the hot season, since in this way losses due to evaporation are reduced and it is not necessary to top up very frequently.

The mineral salt deposits left in the radiator by evaporated water are thus reduced and the efficiency of the cooling system remains unchanged.

If the outdoor temperature is below 0°, check the cooling circuit frequently and if necessary increase the antifreeze concentration (up to maximum 60%).

COOLANT



Do not use the vehicle if the coolant is below the minimum prescribed level.



**Remember: 1 mile = 1.6 km
1 km = 0.625 miles**

Check the coolant level every 2000 km and after long rides; change it every 2 years.



Have the coolant changed by an Aprilia Official Dealer.



Do not remove the expansion tank cap when the engine is hot, since the coolant is under pressure and its temperature is high.

If it gets in contact with the skin or with clothes it may cause severe burns and/or damages.

The coolant is noxious:

DO NOT SWALLOW IT.

KEEP AWAY FROM CHILDREN.

DO NOT DISPOSE OF THE COOLANT IN THE ENVIRONMENT.



CHECKING AND TOPPING UP

DO NOT DISPOSE OF THE FLUID IN THE ENVIRONMENT.

Proceed as follows:

- ◆ Position the vehicle on the centre stand.
- ◆ Unscrew and remove the filling plug (1).
Two reference elements indicating the minimum and maximum level, “**MIN**” and “**MAX**”, are provided inside the expansion tank.
- ◆ Looking through the filling hole, make sure that the coolant level is included between the “**MIN**” and “**MAX**” elements.

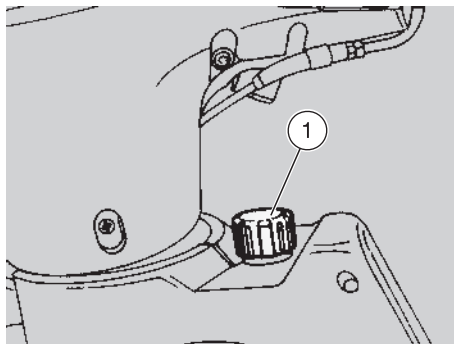

If neither element is covered by the coolant, proceed as follows:

- ◆ Top up until the coolant level reaches approximately the “**MAX**” element.
Do not exceed this level, otherwise the coolant will flow out of the tank when the engine is running.
- ◆ Screw the filling plug (1).

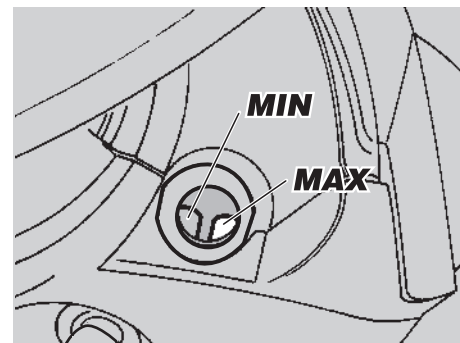

In case of excessive consumption of coolant and in case the expansion tank remains empty, make sure that there are no leaks in the circuit.

Have it repaired by an aprilia Official Dealer.



AUTOMATIC LIGHT SWITCHING VERSION

This vehicle is equipped with a device that switches the lights on automatically when the engine is started.

For this reason, no light switch is provided. The lights can be switched off only by stopping the engine.

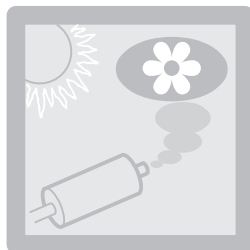

CATALYTIC SILENCER

 **Avoid parking the vehicle catalytic version near dry brush wood or in places easily accessible to children, as the catalytic silencer becomes extremely hot during use; be very careful and avoid any kind of contact before it has completely cooled down.**

The catalytic vehicle is fitted with a silencer with metal catalytic converter of the “platinum-rhodium bivalent” type.

This device provides for the oxidation of the CO (carbon monoxide) and of the HC (unburned hydrocarbons) contained in the exhaust gases, changing them into carbon dioxide and steam, respectively.

Due to the catalytic reaction, the high temperature reached by the exhaust gases makes for the burning of the oil particles, thus keeping the silencer clean and eliminating the exhaust fumes.

To have the catalytic converter function correctly and for long and to reduce possible problems regarding the soiling of the thermal unit and of the exhaust, it is necessary to avoid covering long distances with the engine running at constantly low rpm.

It is sufficient to alternate these periods with periods in which the engine runs at relatively high rpm, even if only for a few seconds, but rather frequently.

What has been stated above assumes particular importance for the cold starting of the engine: in this case, in order to reach a rpm regime sufficient to enable the “priming” of the catalytic reaction, just make sure that the temperature of the thermal unit has reached at least 50°C, which generally occurs a few seconds after starting the engine.

 **Do not use leaded petrol, since it causes the destruction of the catalytic converter.**

INSTRUCTIONS FOR USE



Before departure, always carry out a preliminary checking of the vehicle, to make sure that it functions correctly and safely, see the following table PRELIMINARY CHECKING OPERATIONS.

The non-performance of these checking operations can cause severe personal injuries or damages to the vehicle.



Do not hesitate to consult your **aprilia** Official Dealer in case there is something you do not understand about the functioning of some controls or in case you suspect or discover some irregularities.

It does not take long to carry out a check-up and this operation ensures you much more safety.

PRELIMINARY CHECKING OPERATIONS

Component	Check	Page
Front brake	Check the functioning, the fluid level and make sure there are no leaks. Check the wear of the pads. Top up, if necessary.	22, 23, 45
Rear drum brake	Check the functioning, the idle stroke and the control lever conditions. If the clearance is not correct, adjust it.	24, 46, 47
Accelerator	Make sure that it works smoothly and that it is possible to open and close it completely, in all steering positions. If necessary, adjust and/or lubricate it.	53
2 stroke oil	Check and/or top up, if necessary.	22
Wheel/tyres	Check the tyre surface, the inflation pressure, wear and tear and any damage.	25
Brake levers	Make sure that they work smoothly. If necessary, lubricate the articulations.	22, 23, 24
Steering	Make sure that the steering rotates smoothly, without any clearance or slackening.	48
Centre stand, side stand OPT	Make sure that they work smoothly and that the spring tension brings it back to its normal position. If necessary, lubricate joints and hinges.	—
Fastening elements	Make sure that the fastening elements are not loose. If necessary, adjust or tighten them.	—
Fuel tank	Check the fuel level and top up, if necessary. Make sure there are no leaks or occlusions in the circuit.	21
Coolant 	The coolant level in the expansion tank must be included between the “ MIN ” and “ MAX ” markings. Top up, if necessary.	26, 27
Lights, warning lights, horn and electric devices	Check the proper functioning of all the devices. Change the bulbs or intervene in case of failure.	55 ÷ 64

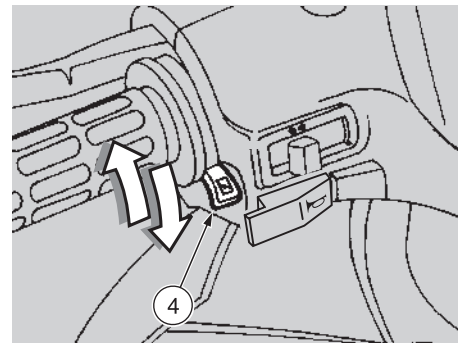
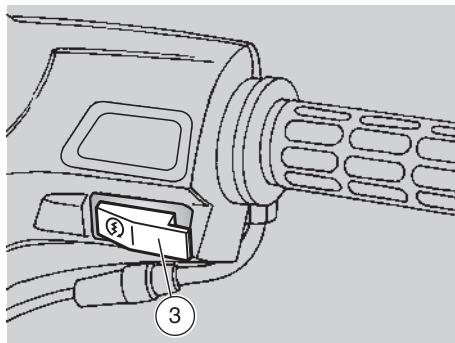
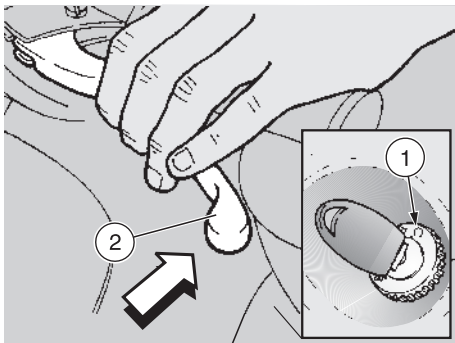

STARTING

⚠ Exhaust gases contain carbon monoxide, which is extremely noxious if inhaled.

Avoid starting the vehicle in closed or badly-ventilated rooms.

The non-observance of this warning may cause loss of consciousness or even lead to death by asphyxia.

Do not get on the vehicle for the starting.

ELECTRIC STARTING

- ◆ Position the vehicle on the centre stand.
- ◆ Turn the ignition switch (1) to position “O”.
- ◆ Lock at least one wheel, by pulling a brake lever (2).

If this operation is not carried out, the start relay receives no current and therefore the engine does not start.

- ◆ Press the start push button “⊗” (3) without accelerating, then release it as soon as the engine starts.

⚠ When the start push button “⊗” is pressed, the 2 stroke oil reserve warning light “⊗” comes on.

With the engine in running condition, when the start push button “⊗” is released, the 2 stroke oil reserve warning light “⊗” must go out; if this does not occur, top up the 2 stroke oil tank, see p. 22 (2 STROKE OIL TANK).

- ◆ If the starting is carried out with cold engine, rotate the cold start lever “|>|” (4) downwards.

⚠ Avoid pressing the start push button “⊗” (3) when the engine is running: this may damage the starter.

- ◆ Do not accelerate and pull the brake levers at the same time until you move off.
- ◆ Warm the engine up before leaving.
- ◆ Once the engine has warmed up, see p. 15 (Coolant temperature indicator ⊗), rotate the cold start lever “|>|” (4) upwards.

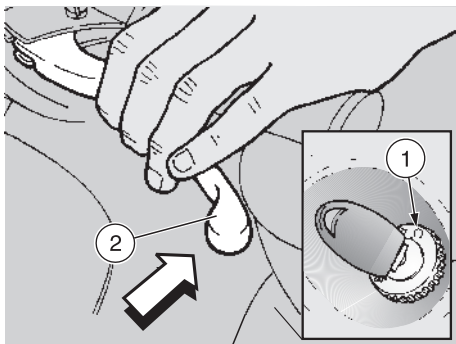

KICK START

For the kick start, proceed as follows:

- ◆ Position the vehicle on the centre stand.
- ◆ Move to the left side of the vehicle.
- ◆ Turn the ignition switch (1) to position “O”.
- ◆ To avoid losing control of the vehicle during the starting, lock both wheels by putting on the brake levers (2).



Do not push down the kick starter with the engine on.

- ◆ Push down the kick starter (3) with your right foot, releasing it immediately. If necessary, repeat the operation until the engine starts.

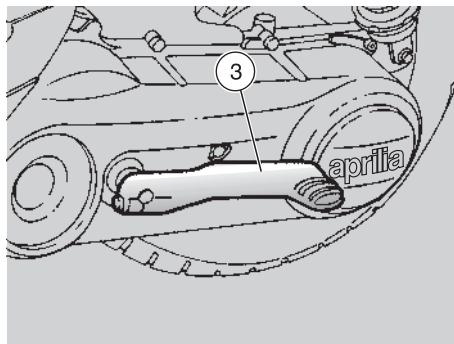

STARTING AFTER A LONG PERIOD OF INACTIVITY

After a long period of inactivity, proceed as follows:

- ◆ Turn the ignition switch (1) to position “O”.
- ◆ Make the starter run for about 10 seconds, in order to ensure the filling up of the float chamber.

To start the engine:

- ◆ Rotate the cold start lever “|>|” (4) downwards.
- ◆ Slightly open the throttle, then carry out the electric starting procedure (or KICK START).

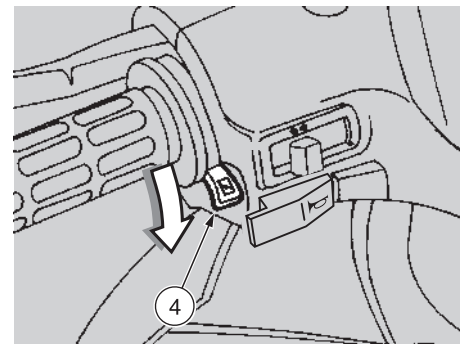

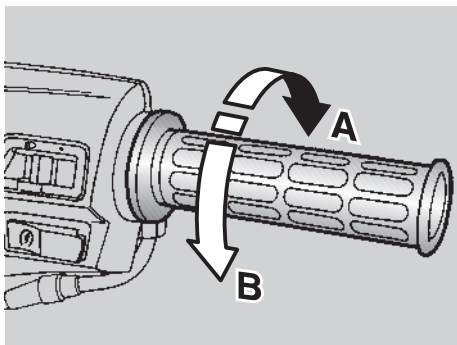

DEPARTURE AND DRIVE

Release the throttle grip (**pos. A**), put on the rear brake, then move the vehicle down the stand.

Get on the vehicle, keeping at least one foot on the ground in order not to lose balance.



Properly adjust the inclination of the rear-view mirrors.

To leave, release the brake lever and accelerate by gently rotating the throttle grip (**pos. B**); the vehicle will start moving.



Avoid opening and closing the throttle grip repeatedly and continuously, so that you do not accidentally lose control of the vehicle.

If you have to brake, close the throttle and put on both brakes in order to obtain uniform deceleration, properly exerting pressure on the braking parts.

By putting on the front brake only or the rear brake only, you reduce the braking force considerably, thus running the risk of locking one wheel and consequently losing grip.

Before beginning to turn, slow down or brake driving at moderate and constant speed or accelerating slightly; avoid braking at the last moment: it would be very easy to skid.

If the brakes are operated continuously on downhill stretches, the friction surfaces can overheat, thus reducing the braking efficiency.

Never drive with the engine off!

In case of wet ground or scarce wheel grip (snow, ice, mud, etc.), drive slowly, avoiding sudden brakings or manoeuvres that could make you lose grip and fall down.



Pay the utmost attention to any obstacle or variation of the ground.



Uneven roads, rails, manhole covers, indications painted on the road surface, building site metal plates become rather slippery by rain. For this reason all these obstacles have to be carefully avoided, driving smoothly and bending the vehicle as little as possible.

Always use the turn indicators timely when you intend to change lane or direction, avoiding sharp and dangerous movements.





If the 2 stroke oil reserve warning light “” comes on during the normal functioning of the engine, this means that the 2 stroke oil reserve is being used; in this case, top up the mixer oil tank, see p. 22 (2 STROKE OIL TANK).



 If the pointer of the coolant temperature indicator “” reaches the red area, stop the engine and check the coolant level, see p. 26 (COOLANT).

RUNNING-IN

 Remember: 1 mile = 1.6 km
1 km = 0.625 miles

 After the first 500 kilometres, carry out the checking operations indicated in the column “After running-in” of the **REGULAR SERVICE INTERVALS CHART**, see p. 36-37, in order to avoid hurting yourself or other people and/or damaging the vehicle.

The running-in of the engine is primary to ensure its correct functioning and its correct functioning. If possible, drive on hilly roads and/or roads with many bends, so that the engine, the suspensions and the brakes undergo a more effective running-in.

For the first 500 km, keep to the following indications:

0-100 km

During the first 100 km put on the brakes with caution, avoiding sharp and prolonged brakings.

This ensures a correct bedding-in of the pads on the brake disc.

0-300 km

Do not keep the throttle grip open more than one half for long stretches.

300-500 km

Do not keep the throttle grip open more than three-fourths for long stretches.

STOPPING

 If possible, avoid stopping abruptly, slowing down suddenly and braking at the last moment.

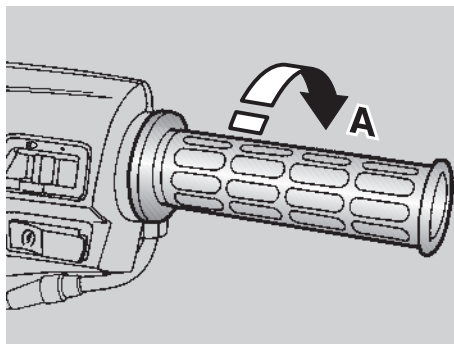

- ◆ Release the throttle grip (**pos. A**) and gradually put on the brakes to stop the vehicle.
- ◆ In case of a brief stop, keep at least one brake on.

PARKING

 Park the vehicle on firm and flat ground, to prevent it from falling down.

Neither lean the vehicle against walls, nor lay it on the ground.

Make sure that the vehicle and especially its red-hot parts do not represent a danger for persons and children.

Do not leave the vehicle unattended when the engine is on or the key is inserted into the ignition switch.

Do not sit on the vehicle when the stand is down.

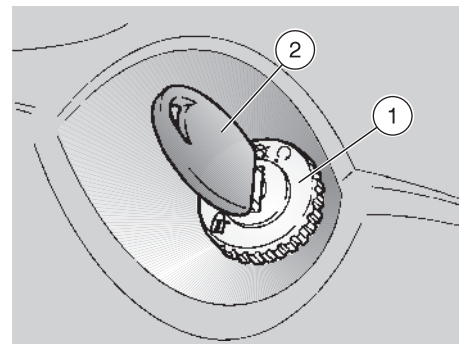

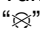
- ◆ Stop the vehicle, see beside (STOPPING).
- ◆ Turn the ignition switch (1) to position “”.
- ◆ Position the vehicle on the stand, see p. 34 (POSITIONING THE VEHICLE ON THE STAND).

 It is not necessary to close the fuel tap when the engine is off, since it is equipped with an automatic closing system.

 Never leave the key in the ignition switch.

- ◆ Lock the steering, see p. 18 (STEERING LOCK) and extract the key (2).

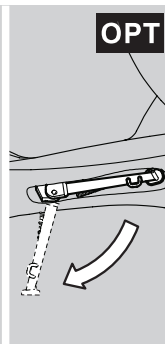
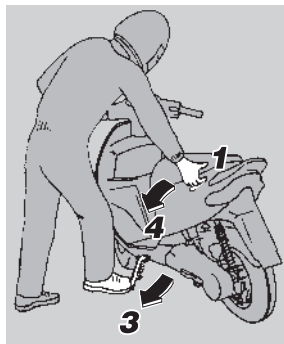
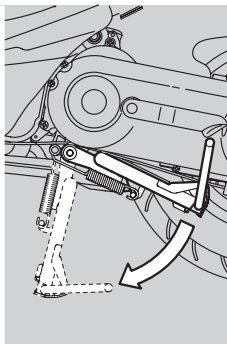
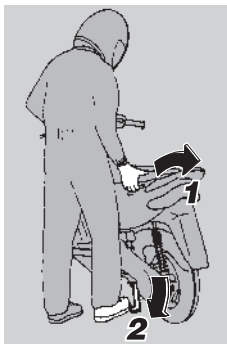

POSITIONING THE VEHICLE ON THE STAND

Carefully read p. 33 (PARKING).

CENTRE STAND

- ◆ Grasp the left handgrip and the left rear grab rail (1).
- ◆ Push down the stand lever (2).

SIDE STAND **OPT**

- ◆ Grasp the left handgrip and the left rear grab rail (1).
- ◆ Push down the side stand with your right foot, extending it completely (3).
- ◆ Incline the vehicle until the stand rests on the ground (4).
- ◆ Steer the handlebar completely leftwards.

 **Make sure that the vehicle is stable.**

SUGGESTIONS TO PREVENT THEFT

NEVER leave the ignition key inserted and always use the steering lock.

Park the vehicle in a safe place, possibly in a garage or a protected place.

If possible, use the appropriate **aprilia** “Body-Guard” armored cable **OPT**, or an additional anti-theft device.

Make sure that all documents are in order and the road tax has been paid.

Write down your personal data and telephone number in the space provided in this page, to facilitate the identification of the owner in case of finding after theft.

SURNAME:

NAME:

ADDRESS:

.....

TELEPHONE NO.:

 **Very often stolen vehicles are identified thanks to the data written on the use/maintenance manual.**





 **Risk of fire.**
Keep fuel and other flammable substances away from the electrical components.

Before beginning any service operations or inspection of the vehicle, switch off the engine and remove the key, wait until the engine and the exhaust system have cooled down and, if possible, lift the vehicles with the proper equipment onto firm and flat ground. Before proceeding, make sure that the room in which you are working is properly ventilated.

Keep away from the red-hot parts of the engine and of the exhaust system, in order to avoid burns.



 **Do not hold any mechanical piece or other parts of the vehicle with your mouth: the components are not edible and some of them are noxious or even toxic.**

 **If not expressly indicated otherwise, for the reassembly of the units repeat the disassembly operations in reverse order.**

In case any maintenance operation should be required, it is advisable to use latex gloves.



Routine maintenance operations can usually be carried out by the user, but sometimes specific tools and specific technical skills may be required.

In case periodic maintenance operations, assistance or technical advice are needed, contact an **aprilia** Official Dealer, who will ensure you prompt and accurate servicing.

Ask your **aprilia** Official Dealer to test the vehicle on the road after a repair or periodic maintenance operation.

In any case, personally carry out the “Preliminary checking operations” after any maintenance operation, see p. 29 (PRELIMINARY CHECKING OPERATIONS).

REGULAR SERVICE INTERVALS CHART

OPERATIONS TO BE CARRIED OUT BY THE **aprilia** Official Dealer (WHICH CAN BE CARRIED OUT EVEN BY THE USER).

Key

- ① = check and clean, adjust, lubricate or change, if necessary;
- ② = clean;
- ③ = change;
- ④ = adjust.



Carry out the maintenance operations more frequently if you use the vehicle in rainy and dusty areas or on uneven ground.

Component	After running-in [500 km (312 mi)]	Every 4000 km (2500 mi) or 12 months	Every 8000 km (5000 mi) or 24 months
Battery - Terminal fastening - Electrolyte level	①	①	–
Spark plug	①	③	–
Carburettor - idling	④	①	–
Air cleaner	①	②	–
Accelerator operation	①	①	–
Brake locking operation	①	①	–
Light system	①	①	–
Stop light switches	–	①	–
Brake fluid	–	①	–
2 stroke oil	every 500 km (312 mi): ①		
Headlight beam direction - operation	–	①	–
Wheels/tyres and inflation pressure	every month: ①		
Rear brake shoe wear	①	①	–
Front brake pad wear	①	every 2000 km (1250 mi): ①	

**OPERATIONS TO BE CARRIED OUT BY
THE *aprilia* Official Dealer.**

Key

① = check and clean, adjust, lubricate or change, if necessary;

② = clean;

③ = change;

④ = adjust.



Carry out the maintenance operations more frequently if you use the vehicle in rainy and dusty areas or on uneven ground.

Component	After running-in [500 km (312 mi)]	Every 4000 km (2500 mi) or 12 months	Every 8000 km (5000 mi) or 24 months
Rear shock absorber	–	–	①
Battery - Terminal fastening	①	–	–
Transmission cables and controls	①	①	–
Variator belt	every 6000 km (3750 mi): ③		
Steering tube bearings and steering slack	①	①	–
Wheel bearings	–	①	–
Brake discs	①	①	–
Removal of deposits from the exhaust	–	②	–
Piston rings	every 12000 km (7500 mi): ①		
Accelerator operation - Mixer	①	①	–
General running of the vehicle	①	①	–
Braking systems/brake discs	①	①	–
Cylinder cooling system	every 20000 km (12500 mi): ② (outside cleaning)		
Rear brake cam pin greasing	–	①	–
Brake fluid	every 2 years: ③		
Coolant 	every 2000 km (1250 mi): ① / every 2 years: ③		
Fork oil and oil seal	every 12000 km (7500 mi): ①		
Transmission oil	③	every 3000 km (1875 mi): ①	every 12000 km (7500 mi) or 2 years: ③
Rear pulley pins	every 12000 km (7500 mi): ③		
Movable/fixed front pulley	every 6000 km (3750 mi): ③		
Variator front pins and guides	every 6000 km (3750 mi): ③		
Wheels/tyres and inflation pressure	①	①	–
Nut, bolt, screw tightening	①	①	–
2 stroke oil reserve warning light	①	①	–
Fuel pipe	every 4000 km (2500 mi): ① / every 4 years: ③		
Braking system pipe	–	①	every 4 years: ③
Mixer oil pipe	①	①	every 2 years: ③
Clutch wear	–	–	①

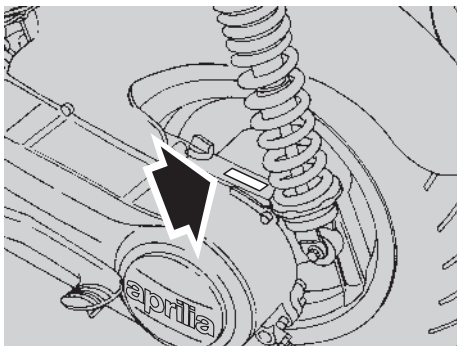

IDENTIFICATION DATA

It is a good rule to write down the frame and engine numbers in the space provided in this manual.

The frame number can be used for the purchase of spare parts.

 **Do not alter the identification numbers if you do not want to incur severe penal and administrative sanctions. In particular, the alteration of the frame number results in the immediate invalidity of the guarantee.**

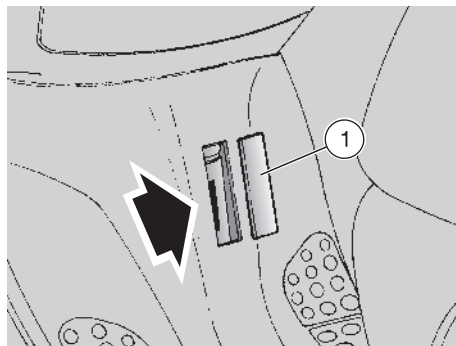

ENGINE NUMBER

The engine number is stamped near the lower support of the rear shock absorber.

Engine no. _____

FRAME NUMBER

The frame number is stamped on the central tube of the frame. To be able to read it, it is necessary to remove the cover (1).

Frame no. _____

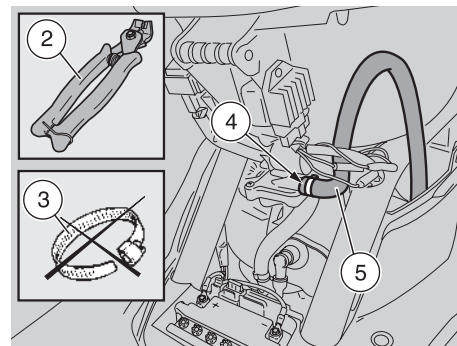

AIR CLEANER

 **Do not use petrol or inflammable solvents to wash the air cleaner, in order to avoid fires or explosions.**

Carefully read p. 35 (MAINTENANCE).

 **Remember: 1 mile = 1.6 km
1 km = 0.625 miles**

Check the conditions of the air cleaner and clean it monthly or every 4000 km, depending on the conditions in which the vehicle is used.

If the vehicle is used on dusty or wet roads, the cleaning operations and any replacement should be carried out more frequently.

To clean the filtering element it is necessary to remove the whole filter casing from the vehicle.

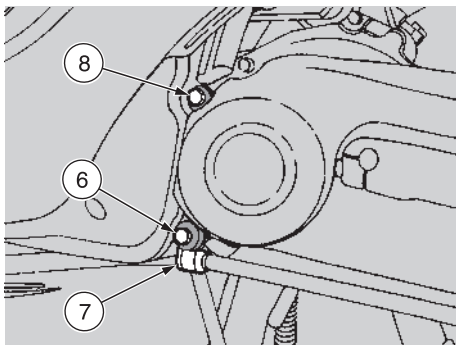

REMOVAL

 **Have the appropriate special tool **OPT** (to be requested to **aprilia** Official Dealer):**

- clamp installation pliers (2).

 **Upon installation, replace the hose clamp that has been removed with a new one having the same dimensions, to be requested to an **aprilia** Official Dealer.**

Do not attempt to reinstall the removed hose clamp, since it is unusable.

Do not replace the removed hose clamp with a screw clamp (3) or with other types of clamp.

- ◆ Remove the inspection cover, see p. 52 (REMOVING THE INSPECTION COVER).

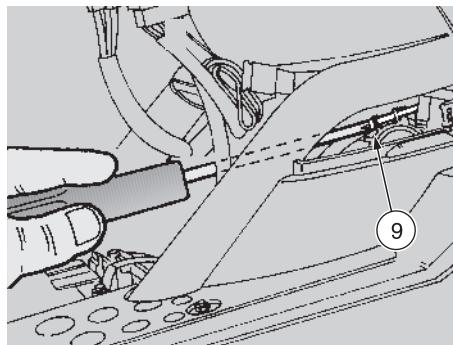

- ◆ Remove the front cover of the rear part of the fairing, see p. 52 (REMOVING THE FRONT COVER OF THE REAR PART OF THE FAIRING).
- ◆ Release the hose clamp (4).
- ◆ Disconnect the pipe (5).

 **Upon reassembly, position the pipe (5) correctly.**

- ◆ Unscrew and remove the screw (6), taking the washer.

 **Upon reassembly, position the rear brake cable eyelet (7) correctly.**

- ◆ Unscrew and remove the screw (8) with the relevant washer.
- ◆ Loosen the screw (9) of the air manifold clamp.
- ◆ Grasp the air manifold in correspondence with the clamp and pull it, thus removing the whole air cleaner casing.

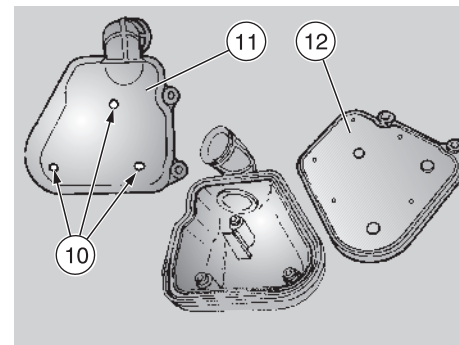

CLEANING THE AIR FILTER

- ◆ Unscrew the three screws (10).
- ◆ Remove the filter case cover (11) and extract the filtering element (12).
- ◆ To clean the filtering element use clean, non-inflammable solvents or solvents with high volatility point, then let it dry thoroughly.
- ◆ Apply a filter oil or a thick oil (SAE 80W-90) on the whole surface of the filtering element, then squeeze it to eliminate the oil in excess.

 **The filter must be well impregnated, though not dripping.**



CHECKING THE TRANSMISSION OIL LEVEL



In case of oil leaks or malfunctions, contact your **aprilia** Official Dealer.

DO NOT DISPOSE OF THE TRANSMISSION OIL IN THE ENVIRONMENT.

Carefully read p. 35 (MAINTENANCE).



**Remember: 1 mile = 1.6 km
1 km = 0.625 miles**

To check the transmission oil level, carry out the following operations every 3000 km or every 12 months:

- ◆ Drive for a few miles until the engine reaches the normal running temperature, see p. 15 (Coolant temperature indicator ) , then stop it.
- ◆ Position the vehicle on the centre stand.

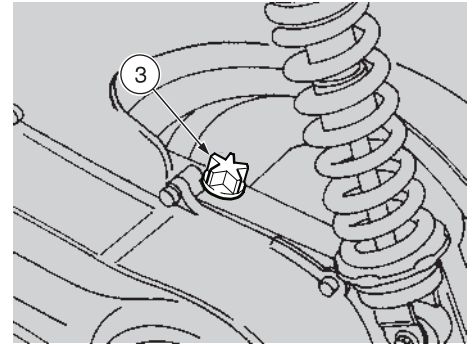
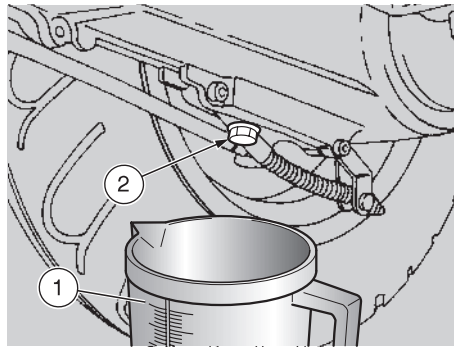

- ◆ Put a graduated container (1) with at least 110 cm³ capacity under the drain plug (2).
- ◆ Unscrew the filling cap (3) and the oil drain plug (2).
- ◆ Let all the oil flow out of the oil pan.
- ◆ Measure the quantity and if it is less than 100 cm³, top up by adding the lacking quantity, see p. 71 (LUBRICANT CHART).
- ◆ Tighten the drain plug (2).
- ◆ Provide for filling up, using the oil collected into the graduated container (1).
- ◆ Tighten the filling cap (3).



Tighten the filling cap and the drain plug thoroughly and make sure that there are no oil leaks.

Periodically check that there are no leaks in correspondence with the oil pan cover seal.

Do not use the vehicle with insufficient lubrication or with contaminated or unsuitable lubricants, since this would accelerate the wear of the moving parts and may also cause irreparable failures.



CHANGING THE TRANSMISSION OIL



In case of oil leaks or malfunctions, contact your **aprilia** Official Dealer.

DO NOT DISPOSE OF THE TRANSMISSION OIL IN THE ENVIRONMENT.

Put it in a sealed container and take it to the filling station where you usually buy it or to an oil salvage center.

Carefully read p. 35 (MAINTENANCE).



**Remember: 1 mile = 1.6 km
1 km = 0.625 miles**

To ensure the efficiency and long life of the vehicle, it is necessary to change the oil after the first 500 km and successively every 12000 km or every 2 years.

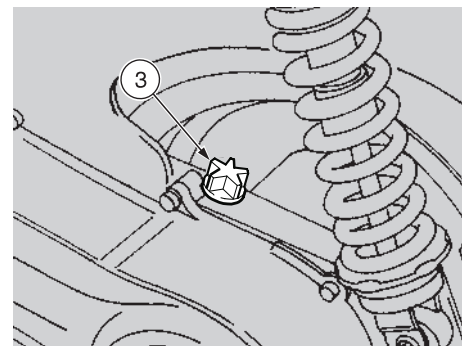
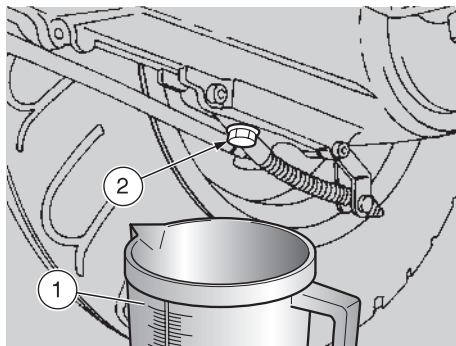

Proceed as follows:

- ◆ Drive for a few miles until the engine reaches the normal running temperature, see p. 15 (Coolant temperature indicator ) , then stop the engine.
- ◆ Position the vehicle on the centre stand.
- ◆ Put a graduated container (1) with at least 110 cm³ capacity under the drain plug (2).
- ◆ Unscrew the filling cap (3) and the oil drain plug (2).
- ◆ Let all the oil flow out of the oil pan.
- ◆ Tighten the drain plug and add 100 cm³ of oil, see p. 71 (LUBRICANT CHART).
- ◆ Tighten the filling cap (3).



Tighten the filling cap and the drain plug thoroughly and make sure that there are no oil leaks.

Periodically check that there are no leaks in correspondence with the oil pan cover seal.

Do not use the vehicle with insufficient lubrication or with contaminated or unsuitable lubricants, since this would accelerate the wear of the moving parts and may also cause irreparable failures.

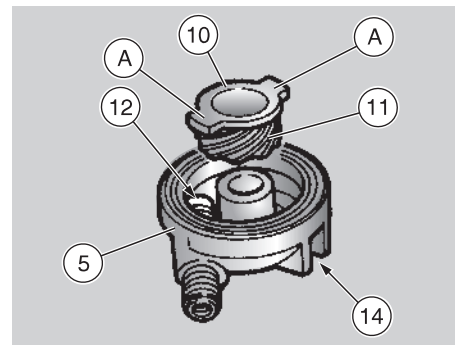
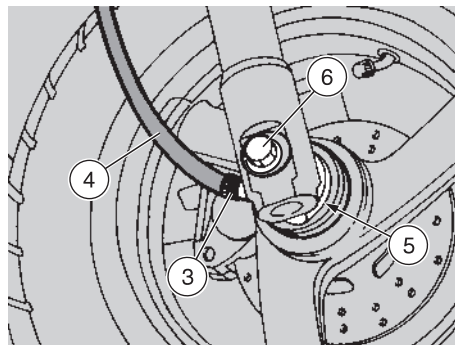
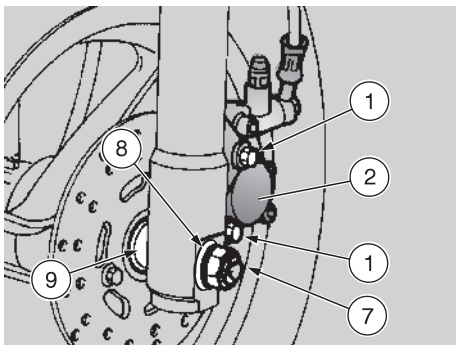

FRONT WHEEL

DISASSEMBLY

Carefully read p. 35 (MAINTENANCE).

 While disassembling the wheel, be careful not to damage the brake pipe, the disc and the pads.

To disassemble the front wheel, proceed as follows:

- ◆ Position the vehicle on the centre stand.

 Prepare a 200 mm high support, the base of which must measure 200 x 200 mm.

- ◆ Place the support under the vehicle and a spongy cloth between them, so that the front wheel can move freely and the vehicle cannot fall down.

 Make sure that the vehicle is stable.

- ◆ Unscrew and remove the two screws (1).

Brake caliper screw driving torque (1): 27 Nm (2.7 kgm).

 Never pull the front brake lever after removing the brake caliper, otherwise the caliper pistons may go out of their seats, thus causing the outflow of the brake fluid.

In this case consult your *aprilia* Official Dealer, who will carry out the proper maintenance operation.

- ◆ Remove the brake caliper (2), by carefully withdrawing it from the brake disc.
- ◆ Unscrew the metal ring (3) and withdraw the odometer cable (4) from the control (5).
- ◆ Lock the wheel pin (6) by means of a spanner.

- ◆ Unscrew and remove the nut (7), taking the washer (8).

Wheel pin-nut driving torque: 50 Nm (5 kgm).

- ◆ Push the wheel pin (6), by carefully acting on the threaded end and using a rubber hammer if necessary.

 Check the arrangement of the speedometer drive (5) and of the spacer ring (9), in order to be able to re-assemble them correctly.

- ◆ Support the front wheel and extract the wheel pin manually.
- ◆ Take the spacer ring (9).
- ◆ Remove the wheel.
- ◆ Disconnect the odometer control (5).

 Handle with care. Prevent the gear (10) from coming out of the odometer control (5).

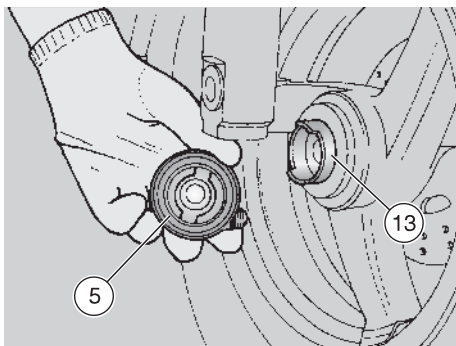

REASSEMBLY

Carefully read p. 35 (MAINTENANCE).



While reassembling the wheel, be careful not to damage the brake pipe, the disc and the pads.

To reassemble the front wheel, proceed as follows:



If the gear (10) has come out of the odometer control (5), clean and grease it, then reassemble it with the crown gear (11) coupled with the worm screw (12).

Do not force the odometer control (5) onto the appropriate wheel hub seat (13), in order not to break the two teeth (A) of the gear (10).

- ◆ Position the odometer control (5) correctly in the appropriate seat in the wheel hub (13).

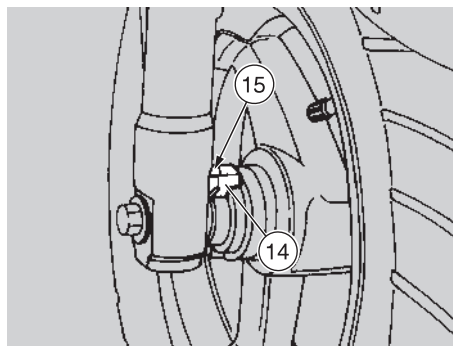

Apply a reasonable quantity of grease uniformly on the wheel pin (6).

- ◆ Position the wheel between the fork rods.
- ◆ Insert the seat (14) of the odometer control (5) in correspondence with the anti-rotation pin (15).
- ◆ Insert the wheel pin (6) from the right side of the vehicle (travelling direction).
- ◆ Insert the spacer (9) between the hub and the fork left rod.
- ◆ Insert the washer (8), lock the rotation of the wheel pin (6) with a spanner, screw and tighten the nut (7).

**Wheel pin nut driving torque:
50 Nm (5 kgm).**

- ◆ Insert the odometer cable (4) in the control (5).
- ◆ Screw and tighten the metal ring (3).

- ◆ Reassemble the brake caliper (2), by carefully inserting it on the brake disc.



Upon reassembly of the brake caliper, replace the caliper fastening screws (1) with two new screws of the same type.

- ◆ Screw and tighten the two screws (1).

**Brake caliper screw driving torque (1):
27 Nm (2.7 kgm).**

- ◆ Remove the support from under the vehicle.



After reassembly, pull the front brake lever repeatedly and check the correct functioning of the braking system.

Check the wheel centering.

Have the driving torques, centering and balancing of the wheel checked by your **aprilia Official Dealer, in order to avoid accidents that may be harmful for you and/or other people.**

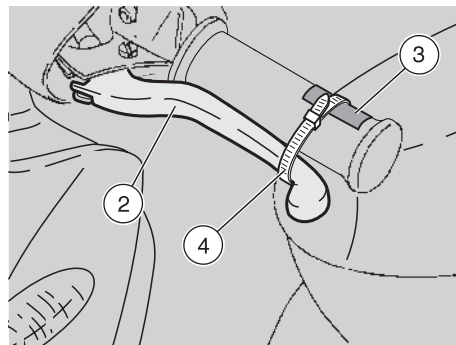
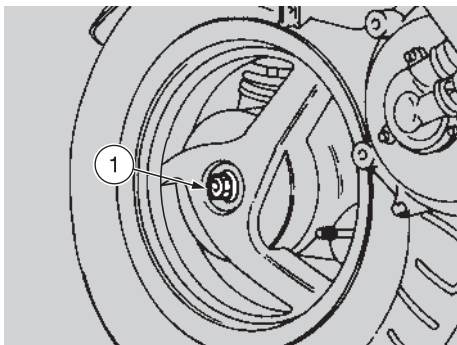

REAR WHEEL

DISASSEMBLY

Carefully read p. 35 (MAINTENANCE).

- ◆ Remove the exhaust silencer, see p. 49 (REMOVING THE EXHAUST SILENCER).

 To unscrew the wheel nut (1), it is necessary to lock the rotation of the wheel.

- ◆ Pull the rear brake lever (2) completely, then put a small piece of cardboard (3) on the grip and keep the rear brake lever pulled by holding it against the grip by means of a plastic band (4).
- ◆ Unscrew and remove the wheel nut (1) and the washer.

 Upon reassembly, change the wheel nut (special type).

Wheel nut driving torque:
110 Nm (11 kgm).

- ◆ Remove the plastic band (4) and take the piece of cardboard (3).
- ◆ Release the rear brake lever.
- ◆ Withdraw the wheel.

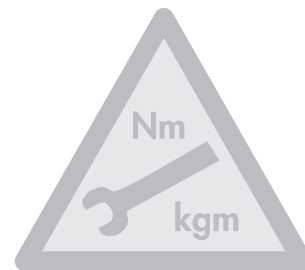

 Use **aprilia** Genuine Spare Parts only.

 After reassembly, pull the rear brake lever repeatedly and check the correct functioning of the braking system.

Check the wheel centering.

Have the driving torques, centering and balancing of the wheel checked by your **aprilia** Official Dealer, in order to avoid accidents that may be harmful for you and/or other people.

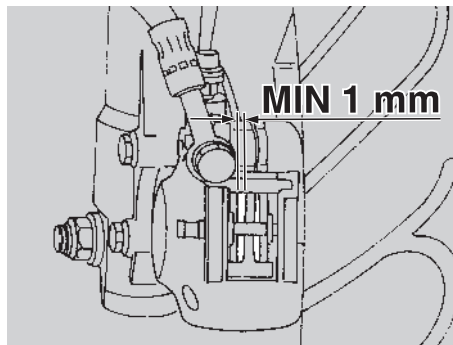
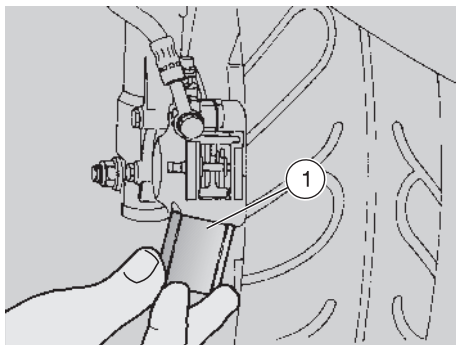

CHECKING THE BRAKE PAD WEAR

Carefully read p. 22 (BRAKE FLUID - recommendations), p. 23 (FRONT BRAKE DISC), p. 35 (MAINTENANCE).

 **Remember: 1 mile = 1.6 km
1 km = 0.625 miles**

Check the brake pad wear after the first 500 km and successively every 2000 km.

The wear of the brake pads depends on the use, on the kind of drive and on the road. The wear will be greater when the vehicle is driven on dirty or wet roads.

To carry out a rapid checking of the wear of the front pads, proceed as follows:

- ◆ Position the vehicle on the centre stand.
- ◆ Remove the brake caliper cover (1).
- ◆ Carry out a visual checking of the friction material thickness by looking between the brake caliper and the pads.

If the thickness of the friction material (even of one pad only) has reduced to about 1 mm, replace both pads.

 **Have the pads changed by your
aprilia Official Dealer.**

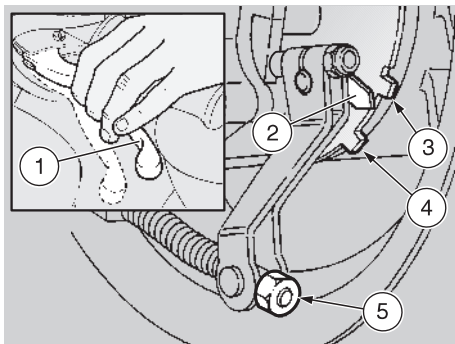

CHECKING THE SHOE WEAR

Carefully read p. 24 (REAR DRUM BRAKE) and p. 35 (MAINTENANCE).

Check the wear of the rear brake shoes after the first 500 km and successively every 4000 km.

To verify the wear of the rear brake shoes, proceed as follows:

- ◆ Pull the rear brake lever (1) completely and keep it pulled.
- ◆ Check the position of the rear brake shoe wear indicator (2).

Position	Wear condition
Indicator between the two reference teeth (3) and (4).	Rear brake shoes within the wear limit.
Indicator on or beyond the lower reference tooth (4).	Rear brake shoes worn. To be replaced.

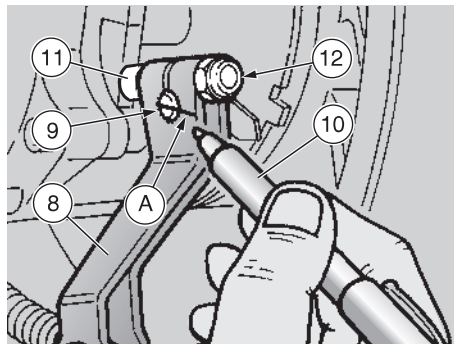

 If the rear brake shoe wear indicator (2) is positioned on or beyond the lower reference tooth (4), contact an aprilia Official Dealer, who will provide for replacing the rear brake shoes.

GREASING THE REAR BRAKE CAM PIN

Carefully read p. 35 (MAINTENANCE).

 **Remember:** 1 mile = 1.6 km
1 km = 0.625 miles

 Grease the rear brake cam pin every 4000 km. If the vehicle is used on dusty roads, this operation must be carried out more frequently.

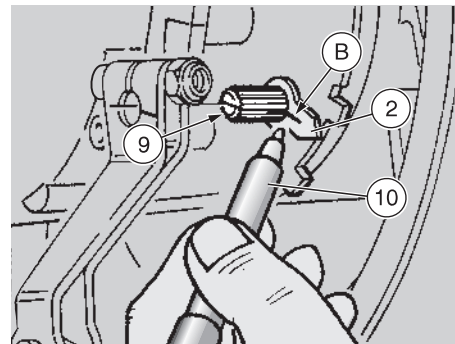

 The greasing of the rear brake cam pin can be difficult or complicated for an unskilled operator.

If necessary, contact your **aprilia** Official Dealer.

If you want to carry out this operation by yourself, keep to the following instructions:

- ◆ Disassemble the rear wheel, see p. 44 (REAR WHEEL).
- ◆ Unscrew and remove the adjuster (5).

 Do not dirt the shoes and the friction material with grease, to avoid compromising the braking efficiency of the vehicle.

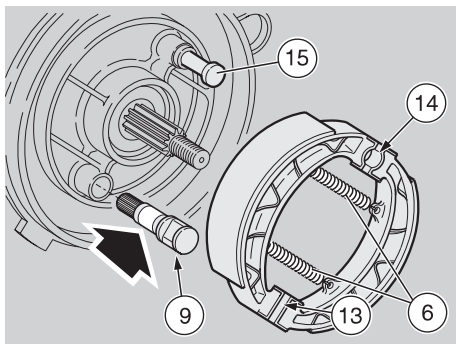

⚠ This operation may be difficult because the springs (6) resist considerably to the removal of the shoes. Be careful not to crush or bruise your hands and fingers.

- ◆ Grasp the inner edge of the two friction elements (7) at its centre and, pulling toward yourself, shake the two shoes, thus releasing them.

☞ Before removing the pin lever (8), mark it.

- ◆ Mark the cam pin (9) and the pin lever (8) with an indelible felt-tip (10), as indicated in the figure (A).
- ◆ Lock the screw (11) with an hexagon spanner and loosen the nut (12).
- ◆ Remove the pin lever (8).

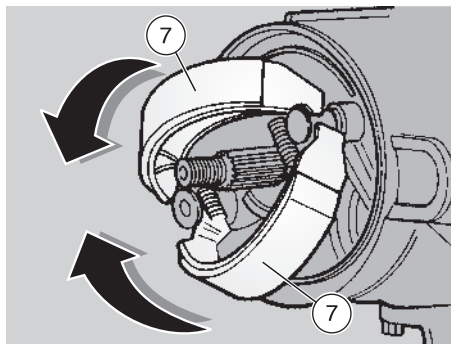

☞ Before removing the rear brake shoe wear indicator (2), mark it.

- ◆ Mark the cam pin (9) and the rear brake shoe wear indicator (2) with an indelible felt-tip (10), as indicated in the figure (B).
- ◆ Withdraw and remove the rear brake shoe wear indicator (2) and the relevant gasket.
- ◆ Withdraw the cam pin (9).

⚠ Moderately grease only the central part of the pin. Avoid dirtying the cam or the areas around the pin seat with grease.

- ◆ Grease the central part of the pin by using grease for kinematic motions, see p. 71 (LUBRICANT CHART).

Upon reassembly:



Do not hit or force the cam pin (9) with any hammer or other object.

- ◆ Manually insert the cam pin (9), by rotating and pushing it moderately.
- ◆ Put back the rear brake shoe wear indicator (2) and the pin lever (8), making the reference marks (A) and (B) coincide with those on the cam pin (9).



The wrong positioning of the rear brake shoe wear indicator results in the wrong measurement of the rear brake shoe wear, with consequent risk of compromising your safety and that of other people and of damaging the vehicle.

- ◆ Put back the two friction elements (7), coupling the plane ends (13) with the cam pin (9) and the shaped ends (14) with the fulcrum pin (15).



Check the correct coupling of the springs (6).

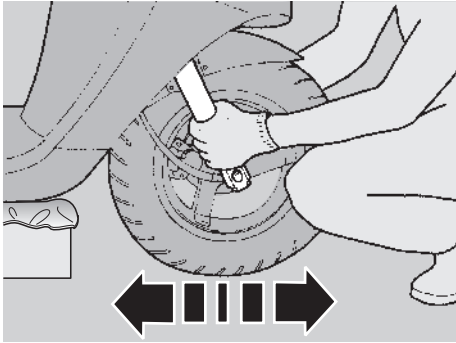

CHECKING THE STEERING

Carefully read p. 35 (MAINTENANCE).

Every now and then it is advisable to check the steering, in order to verify if there are slacks.

To check the steering it is necessary to:

- ◆ Position the vehicle on the centre stand.

 **Prepare a 200 mm high support, the base of which must measure 200 x 200 mm.**

- ◆ Place the support under the vehicle and a spongy cloth between them, so that the front wheel can move freely and the vehicle cannot fall down.

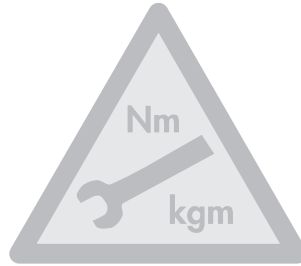

Make sure that the vehicle is stable.

- ◆ Shake the fork in the direction of travel (see figure).



Do not shake the fork excessively, otherwise you may take in consideration the movement of the stand, thus observing an incorrect slack.

Repeat the previous operation more than once.

- ◆ If you find that there is a considerable slack, contact your **aprilia** Official Dealer to restore the optimal steering conditions.

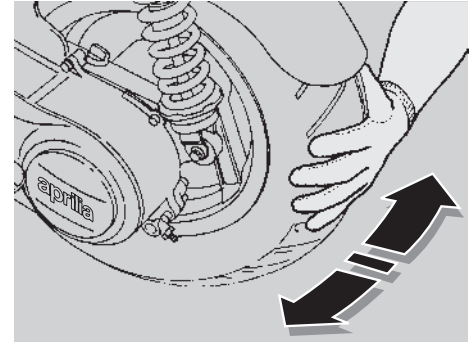

CHECKING THE ENGINE FULCRUM AXIS

Carefully read p. 35 (MAINTENANCE).

Periodically check the slack existing between the engine pin bushings.

To carry out this operation, proceed as follows:

- ◆ Position the vehicle on the centre stand.
- ◆ Shake the wheel perpendicularly to the direction of travel (see figure).
- ◆ If you find any slack, make sure that all the fastening elements of the fulcrum axis are well tightened.



If the slack persists, contact your **aprilia Official Dealer.**

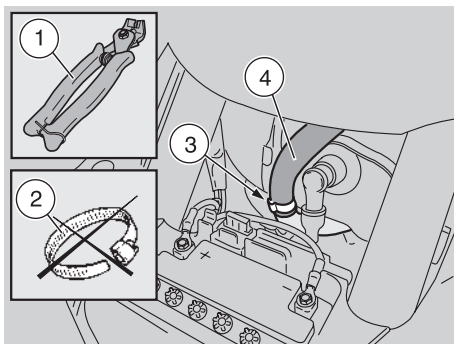

REMOVING THE EXHAUST SILENCER

Carefully read p. 35 (MAINTENANCE).

- ◆ Position the vehicle on the centre stand.



Before performing the operations described below, let the engine and the exhaust silencer cool down until they have reached room temperature, in order to avoid burns.



Have the appropriate special tool **OPT** (to be requested to **aprilia** Official Dealer):

- clamp installation pliers (1).

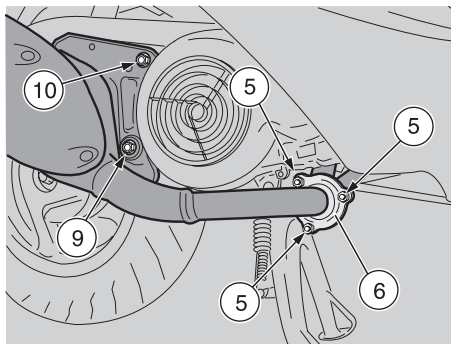

Upon installation, replace the hose clamp that has been removed with a new one having the same dimensions, to be requested to an **aprilia** Official Dealer.

Do not attempt to reinstall the removed hose clamp, since it is unusable.

Do not replace the removed hose clamp with a screw clamp (2) or with other types of clamp.

- ◆ Remove the inspection cover, see p. 52 (REMOVING THE INSPECTION COVER).
- ◆ Release the hose clamp (3).
- ◆ Disconnect the pipe (4).



Upon reassembly, position the pipe (4) correctly.

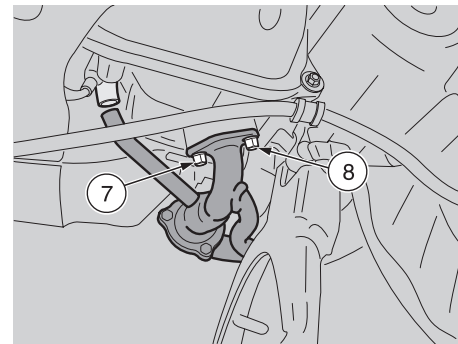

DO NOT adjust the nuts (5) of the flange (6), but follow the procedure described below

- ◆ Unscrew and remove the screws (7) and (8).

Screw (7) and (8) driving torque:
12 Nm (1.2 kgm).

- ◆ Unscrew and remove the two screws (9) and (10) that fasten the exhaust silencer to the engine.

Screw (9) and (10) driving torque:
25 Nm (2.5 kgm).

- ◆ Remove the exhaust silencer.



Upon reassembly, replace the gasket positioned between the exhaust manifold and the silencer with a new one.

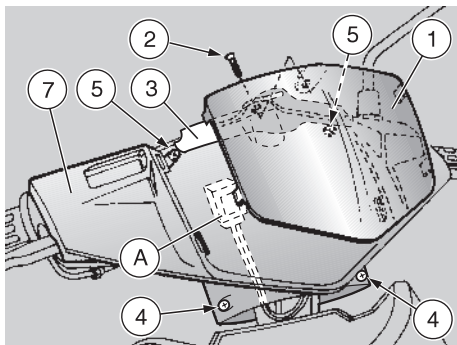

REMOVING THE FRONT HANDLEBAR COVER

Carefully read p. 35 (MAINTENANCE).

- ◆ Position the vehicle on the centre stand.

 Support the front part of the fairing (1), in order to prevent it from accidentally falling down.

- ◆ Unscrew and remove the screw (2).

 Proceed with care. Do not damage the tangs and/or their seats.

Handle the plastic and painted components with care and avoid scraping or damaging them.

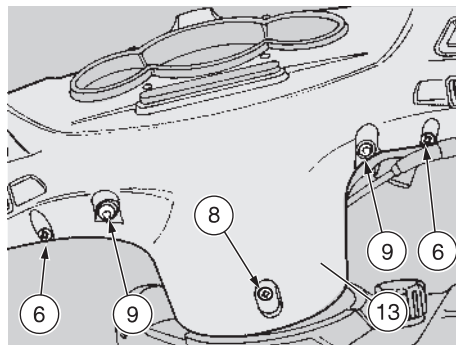

- ◆ Remove the front part of the fairing (1).
- ◆ Remove the gasket (3).
- ◆ Unscrew and remove the screws (4).
- ◆ Unscrew and remove the screws (5).
- ◆ Unscrew and remove the screws (6).

 Handle with care. Do not force the electric cable.

- ◆ Partially remove the front handlebar cover (7).
- ◆ Remove the blinking (A).
- ◆ Remove the front handlebar cover (7).

REMOVING THE REAR HANDLEBAR COVER

Carefully read p. 35 (MAINTENANCE).

- ◆ Remove the front handlebar cover, see beside (REMOVING THE FRONT HANDLEBAR COVER).

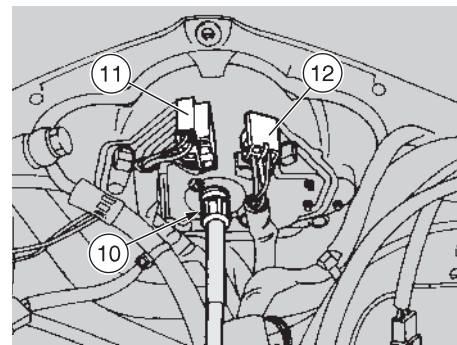

- ◆ Unscrew and remove the screw (8).
- ◆ Unscrew and remove the screws (9).
- ◆ Unscrew the metal ring (10) and withdraw the odometer cable from the coupling.
- ◆ Disconnect the two electric terminals (11) and (12).

 The rear handlebar cover (13) (complete with switches, instruments and indicators) remains connected to the electric cables and therefore cannot be completely removed. Proceed with care in order to avoid damaging the components.

- ◆ Partially remove the rear handlebar cover (13).

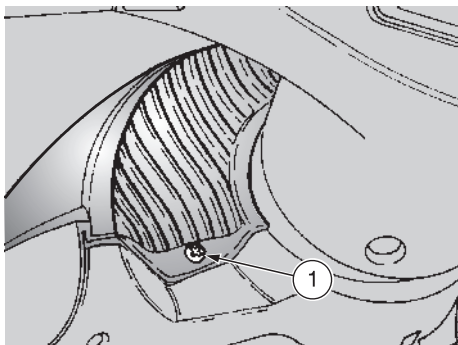

REMOVING THE FRONT TRANSPARENT SCREEN

Carefully read p. 35 (MAINTENANCE).

- ◆ Position the vehicle on the centre stand.
- ◆ Rotate the handlebar completely rightwards.
- ◆ Unscrew and remove the screw (1).



Proceed with care.
Do not damage the tangs and/or their seats.

Handle the plastic and painted components with care and avoid scraping or damaging them.

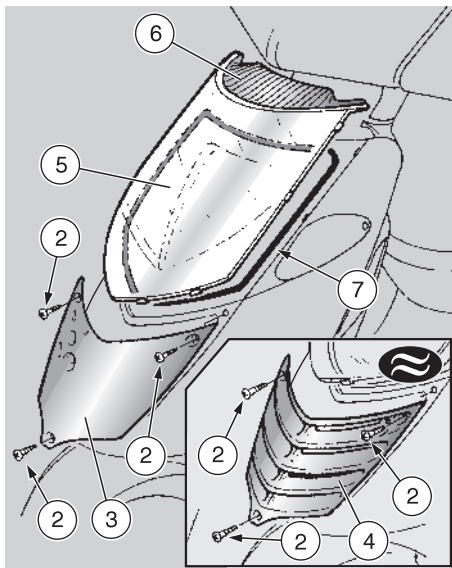

- ◆ Rotate the handlebar to the central position.
- ◆ Unscrew and remove the three screws (2).
- ◆ Withdraw the front cover (3) (radiator grid (4)) by pulling it downwards.
- ◆ Remove the front transparent screen (5), together with the collar (6), by withdrawing it in the travelling direction.

Upon reassembly:

- ◆ Make sure that the gasket (7) is correctly inserted in its seat.

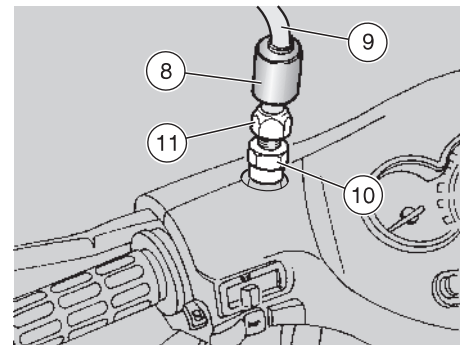

REMOVING THE REAR-VIEW MIRROR

Carefully read p. 35 (MAINTENANCE).

- ◆ Position the vehicle on the centre stand.
- ◆ Lift the protection element (8).



Support the rear-view mirror (9), to prevent it from accidentally falling down.

- ◆ Keep the screw (10) locked and loosen the nut (11) completely.
- ◆ Remove the rear-view mirror (9).

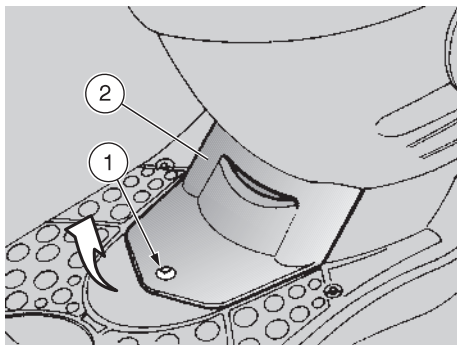

REMOVING THE INSPECTION COVER

Carefully read p. 35 (MAINTENANCE).

 Handle the painted components with care and avoid scraping or damaging them.

- ◆ Position the vehicle on the centre stand.
- ◆ Unscrew and remove the screw (1).
- ◆ Lift the front part of the inspection cover (2) and remove it by withdrawing it in the travelling direction.

 Upon reassembly, correctly insert the two side tangs in their seats.

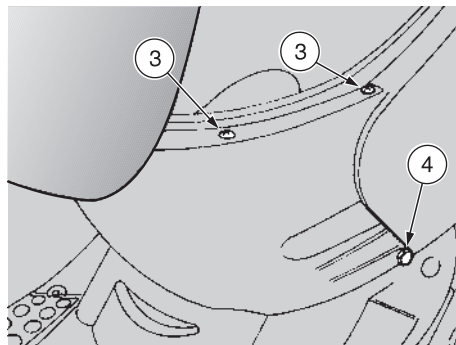



REMOVING THE FRONT COVER OF THE REAR PART OF THE FAIRING

Carefully read p. 35 (MAINTENANCE).

 Handle the plastic and painted components with care and avoid scraping or damaging them.

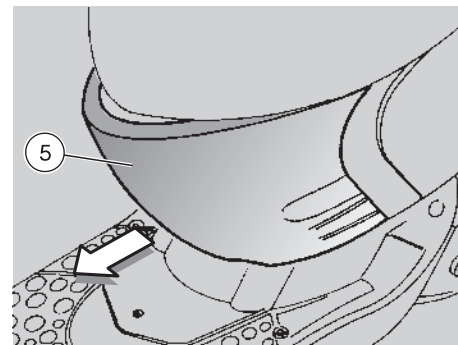
- ◆ Position the vehicle on the centre stand.
- ◆ Lift the saddle, see p. 19 (UNLOCKING/LOCKING THE SADDLE).
- ◆ ★ Unscrew and remove the two upper screws (3).
- ◆ ★ Unscrew and remove the side screw (4).



 The front cover of the rear part of the fairing can be removed (and put back) only with lowered saddle.

 Before lowering and locking the saddle, make sure that you have not left the key in the crash-helmet/glove compartment.

- ◆ Lower the saddle.
- ◆ Remove the front cover of the rear part of the fairing (5) by withdrawing it in the travelling direction.

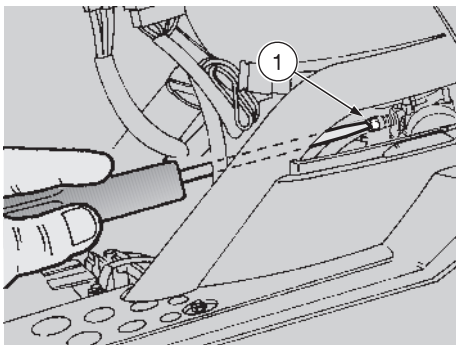

IDLING ADJUSTMENT

Carefully read p. 35 (MAINTENANCE).

 **Remember: 1 mile = 1.6 km
1 km = 0.625 miles**

Adjust the idling after the first 500 km and every time it is irregular.

To carry out this operation, proceed as follows:

- ◆ Drive for a few miles until the engine reaches the normal running temperature, see p. 15 (Coolant temperature indicator ) , then stop the engine.
- ◆ Position the vehicle on the centre stand.
- ◆ Remove the inspection cover, see p. 52 (REMOVING THE INSPECTION COVER).
- ◆ Connect an electronic revolution counter to the spark plug cable.
- ◆ Start the engine.

The minimum speed of the engine (idling) must be about 1800 ± 100 rpm; in this case the engine does not make the rear wheel rotate.

If necessary:

- ◆ Remove the front cover of the rear part of the fairing, see p. 52 (REMOVING THE FRONT COVER OF THE REAR PART OF THE FAIRING).
- ◆ Act on the adjusting screw (1) positioned on the carburettor.

By **SCREWING IT** (clockwise), you increase the engine rpm.

By **UNSCREWING IT** (anticlockwise), you decrease the engine rpm.

- ◆ Twist the throttle grip, accelerating and decelerating a few times to make sure that it functions correctly and to check if the idling speed is constant.

 **Do not act on the air adjusting screw, to avoid variations of the carburation setting.**



If necessary, contact your aprilia Official Dealer.

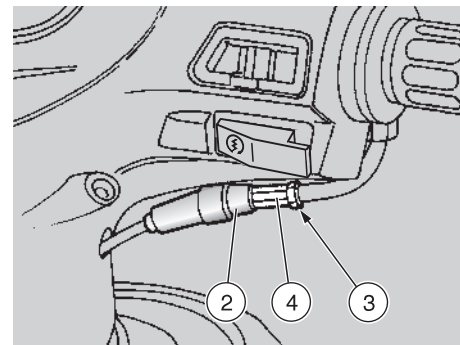

ADJUSTING THE ACCELERATOR CONTROL

Carefully read p. 35 (MAINTENANCE).

The ideal slack of the accelerator control should be about 2-3 mm.

To adjust the slack, proceed as follows:

- ◆ Position the vehicle on the centre stand.
- ◆ Remove the protection element (2).
- ◆ Loosen the nut (3) (by turning it clockwise).
- ◆ Act on the adjuster (4), positioned at the beginning of the accelerator control cable.

After the adjustment:

- ◆ Tighten the nut (3) (by turning it anticlockwise), thus locking the adjuster (4) and put back the protection element (2).

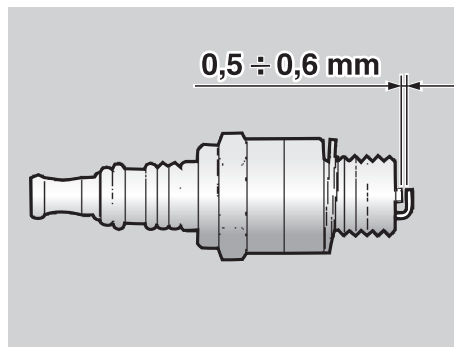
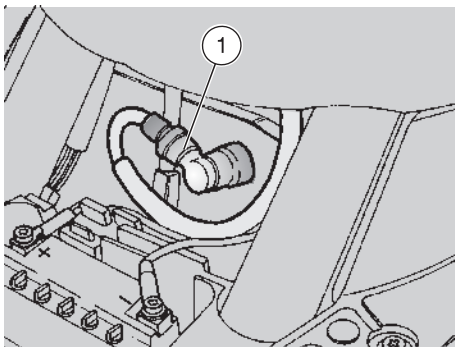

SPARK PLUG

Carefully read p. 35 (MAINTENANCE).

 **Remember: 1 mile = 1.6 km
1 km = 0.625 miles**

Check the spark plug after the first 500 km; change it every 4000 km.

Periodically remove the spark plug and clean it carefully, removing carbon deposits; change it if necessary.

To reach the spark plug:

- ◆ Remove the inspection cover, see p. 52 (REMOVING THE INSPECTION COVER).

To remove and clean the spark plug:

- ◆ Take off the spark plug cap (1).
 - ◆ Remove all the dirt from the base of the spark plug, then unscrew it with the spanner you will find in the tool kit and extract it from its seat, taking care that neither dust nor other substances enter the cylinder.
 - ◆ Make sure that there are neither carbon deposits, nor corrosion marks on the electrode and on the central porcelain part; if necessary, clean them with the special cleaners for spark plugs, with an iron wire and/ or a metal brush.
 - ◆ Energetically blow some air, in order to prevent the removed residues from getting into the engine.
- If the spark plug has crackings on the insulating material, corroded electrodes or excessive deposits, it must be changed.

- ◆ Check the spark plug gap with a thickness gauge.
The gap must be **0,5 ÷ 0,6 mm**; if necessary adjust it, carefully bending the earth electrode.
- ◆ Make sure that the washer is in good conditions. With the washer on, screw the spark plug by hand in order not to damage the thread.
- ◆ Tighten the spark plug by means of the spanner you will find in the tool kit, giving it half a turn to compress the washer.



The spark plug must be well tightened, otherwise the engine may overheat and be seriously damaged.

Use the recommended type of spark plug only, see p. 67 (TECHNICAL DATA), in order not to compromise the life and performance of the engine.

- ◆ Position the spark plug cap (1).
- ◆ Put back the inspection cover.

BATTERY

Carefully read p. 35 (MAINTENANCE).

 Remember: 1 mile = 1.6 km
1 km = 0.625 miles

Check the electrolyte level and the tightening of the terminals after the first 500 km and successively every 4000 km or 12 months.

 The electrolyte in the battery is toxic and caustic and if it gets in contact with the skin it can cause burns, since it contains sulphuric acid.

Wear protection clothes, a face mask and/or goggles during maintenance operations.

In case of contact with the skin, rinse with plenty of water.

In case of contact with the eyes, rinse with plenty of water for 15 minutes, then consult an oculist without delay.

If the electrolyte is accidentally swallowed, drink a lot of water or milk, then continue drinking milk of magnesia or vegetable oil and consult a doctor without delay.

The battery gives off explosive gases; keep it away from flames, sparks, cigarettes and any other source of heat. During the recharging or the use, make sure that the room is properly ventilated and avoid inhaling the gases released during the recharging.

KEEP AWAY FROM CHILDREN

 Never invert the connection of the battery cables.

Do not incline the vehicle too much, in order to avoid dangerous leaks of the battery fluid.

Connect and disconnect the battery with the ignition switch in position "⊗". Connect first the positive cable (+) and then the negative cable (-).

Disconnect following the reverse order.

The electrolyte is corrosive.

Do not pour or spill it, especially on the plastic parts.

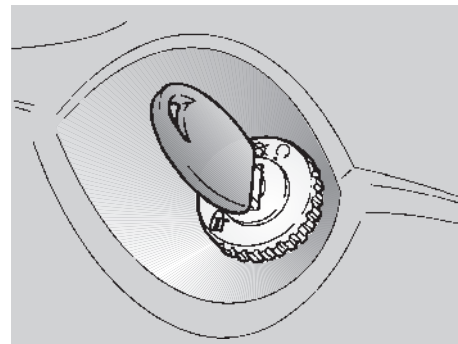

LONG INACTIVITY OF THE BATTERY

If the vehicle remains unused for a long period:

- ◆ Remove the battery, see p. 56 (REMOVING THE BATTERY) and put it in a cool and dry place.
- ◆ Recharge it completely, by using a trickle charge, see p. 57 (RECHARGING THE BATTERY).

If the battery remains on the vehicle, disconnect the cables from the terminals.

It is important to check the charge periodically (about once a month), during the winter or when the vehicle remains unused, in order to prevent the deterioration of the battery.

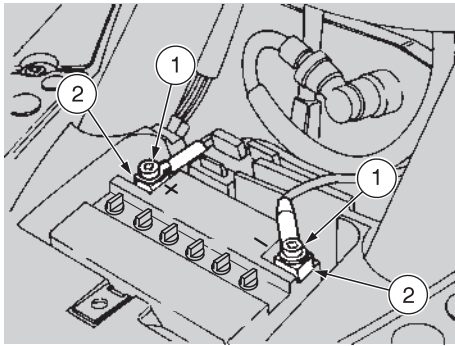

CHECKING AND CLEANING THE TERMINALS

Carefully read p. 55 (BATTERY).

- ◆ Remove the inspection cover, see p. 52 (REMOVING THE INSPECTION COVER).
- ◆ Make sure that the cable terminals (1) and the battery terminals (2) are:
 - in good conditions (and not corroded or covered with deposits);
 - covered with special grease or Vaseline.

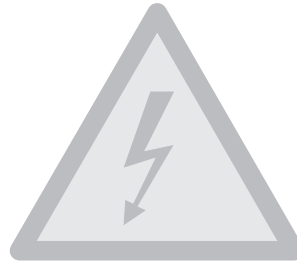

If necessary:

- ◆ Make sure that the ignition switch is in position "OFF".
- ◆ Disconnect first the negative (-) and then the positive cable (+).
- ◆ Brush with a wire brush to eliminate any sign of corrosion.
- ◆ Reconnect first the positive (+) and then the negative cable (-).
- ◆ Cover the terminals with special grease or Vaseline.

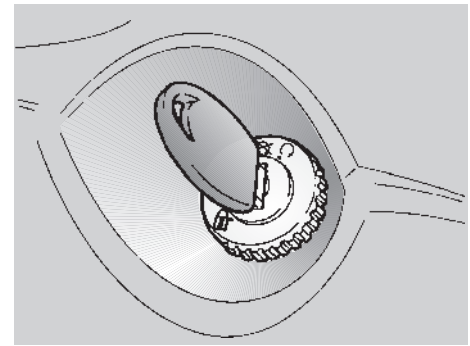

REMOVING THE BATTERY

Carefully read p. 55 (BATTERY).

- ◆ Remove the inspection cover, see p. 52 (REMOVING THE INSPECTION COVER).
- ◆ Make sure that the ignition switch is in position "OFF".
- ◆ Disconnect first the negative (-) and then the positive cable (+).
- ◆ Remove the battery breather pipe.
- ◆ Remove the battery from its compartment and put it on a flat surface, in a cool and dry place.



Once it has been removed, the battery must be stored in a safe place and kept away from children.

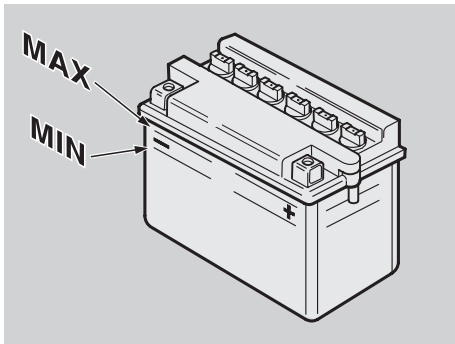

CHECKING THE ELECTROLYTE LEVEL

Carefully read p. 55 (BATTERY).

- ◆ Remove the battery from its compartment, see p. 56 (REMOVING THE BATTERY).
- ◆ Make sure that the fluid level is included between the two “MIN” and “MAX” notches stamped on the battery side.

Otherwise:

- ◆ Unscrew and remove the element plugs.



Top up with distilled water only. Do not exceed the “MAX” mark, since the electrolyte level increases during the recharge.

- ◆ Top up by adding distilled water.

RECHARGING THE BATTERY

Carefully read p. 55 (BATTERY).

- ◆ Remove the battery from its compartment, see p. 56 (REMOVING THE BATTERY).
- ◆ Unscrew and remove the element plugs.
- ◆ Check the electrolyte level, see beside (CHECKING THE ELECTROLYTE LEVEL).
- ◆ Connect the battery with a battery charger.
- ◆ A recharge with an amperage equal to 1/10th of the battery capacity is recommended.
- ◆ After the recharging operation, check the electrolyte level again and if necessary top up with distilled water.
- ◆ Replace the element plugs.



Reinstall the battery only 5-10 minutes after disconnecting the recharge equipment, since the battery keeps sending out extremely inflammable hydrogen gas for a short lapse of time.

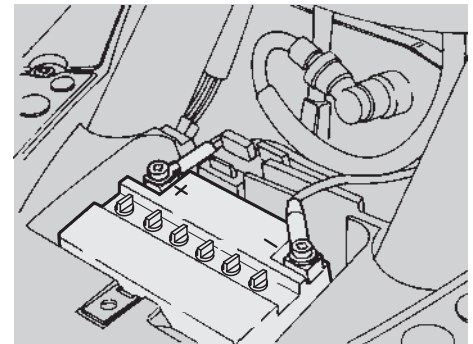

INSTALLING THE BATTERY

Carefully read p. 55 (BATTERY).

- ◆ Put the battery in its container.
- ◆ Connect the breather pipe.



Always connect the battery breather pipe, to prevent the sulphuric acid vapours from corroding the electric system, painted parts, rubber elements or gaskets when they exit the breather pipe itself.

- ◆ Connect, in order, the positive (+) and negative (-) cable.
- ◆ Cover the terminals with special grease or Vaseline.
- ◆ Put back the inspection cover, see p. 52 (REMOVING THE INSPECTION COVER).

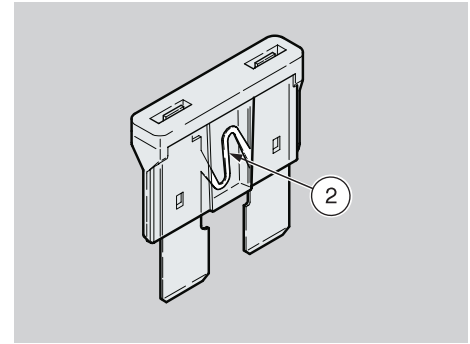
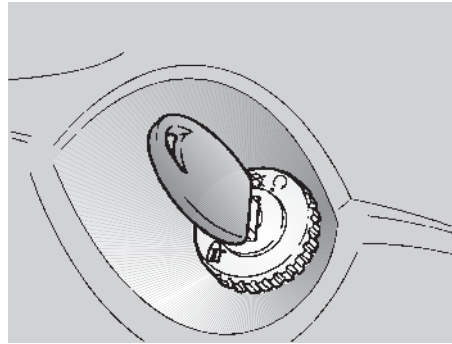
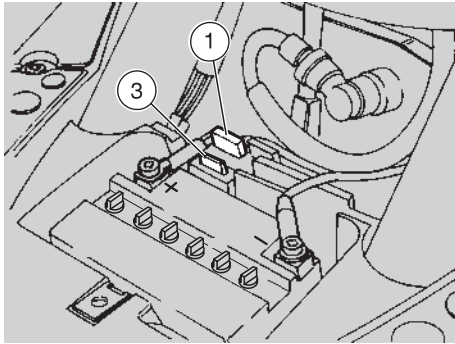

CHANGING THE FUSE

Carefully read p. 35 (MAINTENANCE).



Do not repair faulty fuses.

Never use fuses different from the recommended ones.

The use of unsuitable fuses may cause damages to the electric system or, in case of short circuit, even a fire.



If a fuse blows frequently, there probably is a short circuit or an overload in the electric system.

In this case it is advisable to consult an *aprilia* Official Dealer.

If an electric component does not work or works irregularly, or if the vehicle fails to start, it is necessary to check the fuse (1).

For the checking, proceed as follows:

- ◆ Turn the ignition switch to position “⊗”, to avoid any accidental short circuit.
- ◆ Remove the inspection cover, see p. 52 (REMOVING THE INSPECTION COVER).
- ◆ Extract the fuse (1) and check if the filament (2) is broken.
- ◆ Before replacing the fuse, try to find out the cause of the trouble, if possible.
- ◆ Then replace the damaged fuse with the spare fuse (3) or with a new one having the same amperage.



If you use one of the spare fuse (3), put a new fuse in the suitable seat.

ARRANGEMENT OF THE FUSE

7.5 A fuse from the battery to:

all the electric loads, excluding the light circuit, which is fed with alternate current.

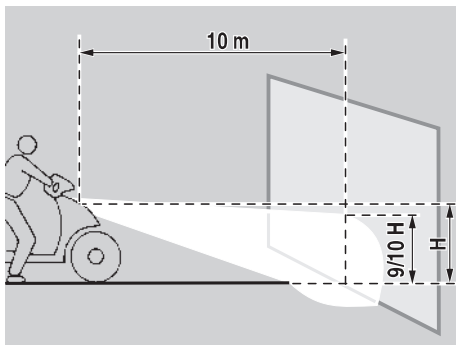

ADJUSTING THE VERTICAL HEADLIGHT BEAM

To rapidly check the correct direction of the beam, place the vehicle on flat ground, 10 m away from a wall.

Turn on the low beam, sit on the vehicle and make sure that the beam projected on the wall is slightly under the horizontal line of the headlight (about 9/10th of the total height).

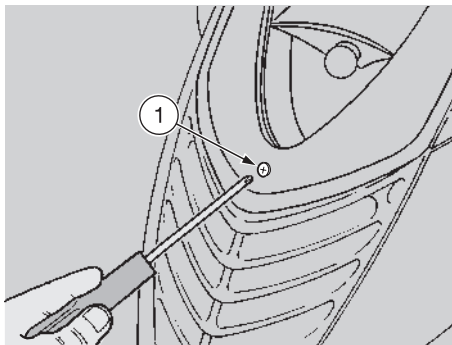

To adjust the headlight beam:

- ◆ Remove the front transparent screen, see p. 51 (REMOVING THE FRONT TRANSPARENT SCREEN).
- ◆ Act on the suitable screw (1) by means of a screwdriver.

By TURNING IT CLOCKWISE, you set the beam upwards.

By TURNING IT ANTICLOCKWISE, you set the beam downwards.

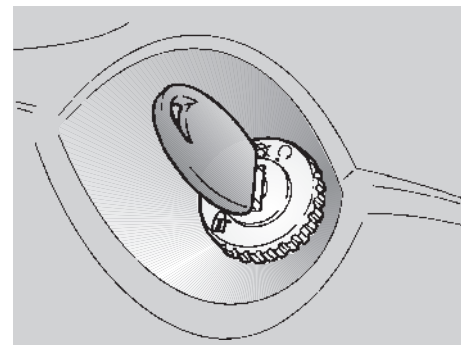

BULBS

Carefully read p. 35 (MAINTENANCE).

! Before changing a bulb, position the vehicle on the centre stand and turn the ignition switch to position "⊗". Change the bulb wearing clean gloves or using a clean and dry cloth.

! Do not leave fingerprints on the bulb, since these may cause its overheating and consequent breakage. If you touch the bulb with bare hands, remove any fingerprint with alcohol, in order to prevent it from blowing.

DO NOT FORCE THE ELECTRIC CABLES.

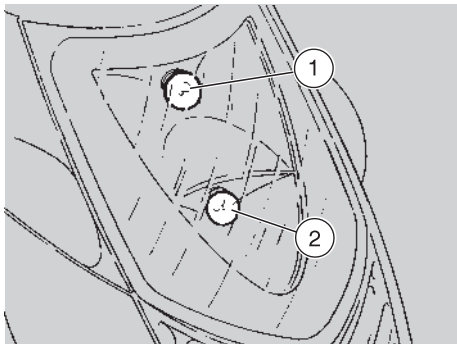

CHANGING THE HEADLIGHT BULBS

Carefully read p. 59 (BULBS).

The headlight contains:

- ◆ An upper, low beam bulb (1).
- ◆ A lower, low beam bulb (2).

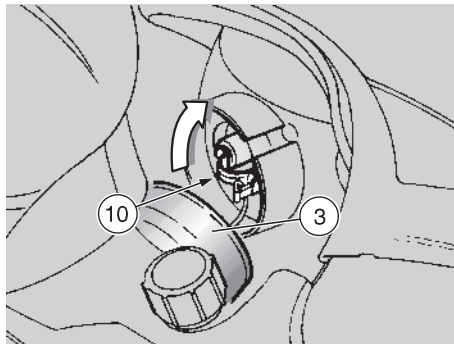

To reach the bulbs, proceed as follows:

UPPER BULB

- ◆ Remove the front transparent screen, see p. 51 (REMOVING THE FRONT TRANSPARENT SCREEN).
- ◆ Reach the bulb protection element (3) from above.

LOWER BULB

- ◆ Open the door (4) of the glove compartment (5).
- ◆ Remove any object positioned in the left part of the compartment.
- ◆ Unscrew and remove the screw (6).
- ◆ Extract the cover (7), withdrawing it from the pin (8) present on the bottom of the glove compartment.
- ◆ Reach the bulb protection element (9).

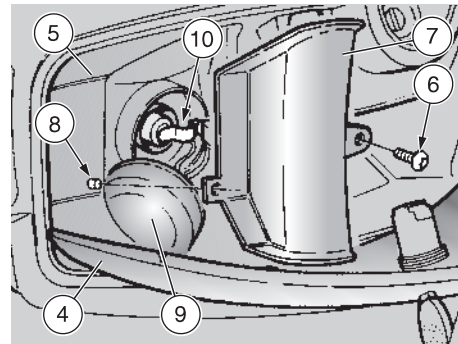

To change the bulbs, proceed as follows:

- ◆ Manually withdraw the protection element of the bulb to be replaced.
- ◆ Rotate the check tang (10) positioned at the back of the bulb socket upwards.
- ◆ Extract the bulb and replace it with a new one of the same type.



Upon reassembly of the upper bulb protection element, position the cable outlet upwards and on the right, in order to prevent the cables from rubbing against the steering column cables and avoid their wear.

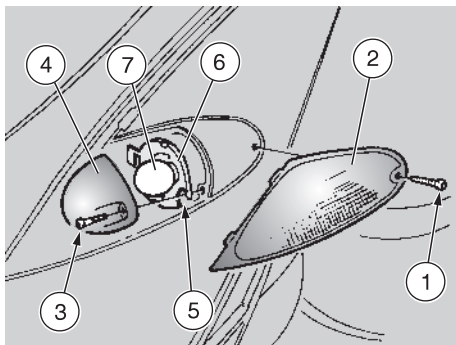

CHANGING THE FRONT DIRECTION INDICATOR BULBS

Carefully read p. 59 (BULBS).

To change the bulbs:

- ◆ Unscrew and remove the screw (1).

 **When removing the protection screen, proceed with care, in order not to break the tangs.**

- ◆ Rotate the protection screen (2) towards the inside, until releasing the two tangs, then remove it.
- ◆ Unscrew and remove the screw (3).

 **When removing the coloured screen, proceed with care, in order not to break the tang.**

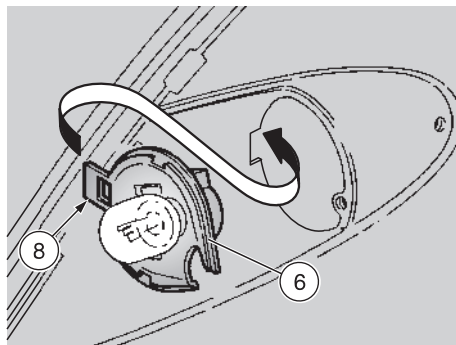

- ◆ Rotate the coloured screen (4) towards the inside, until releasing the tang, then remove it.
- ◆ Act on the opening (5) and lock the bulb socket (6); press the bulb (7) moderately, rotate it anticlockwise and extract it.

 **To install the new bulb: introduce the bulb in the bulb socket, making sure that the two guide pins coincide with the relevant guides on the bulb socket.**

- ◆ Correctly install a new bulb of the same type.

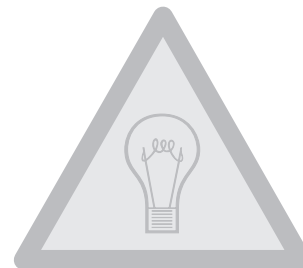

For the reassembly:

If the bulb socket (6) has come out of its seat:

- ◆ Correctly insert the tang (8) in its seat.

 **Correctly insert the tangs of the coloured screen (4) and of the protection screen (2) in their seats.**

 **Tighten the screw (1) and the screw (3) moderately and with great care, in order to avoid damaging the protection screen (2) and the coloured screen (4).**

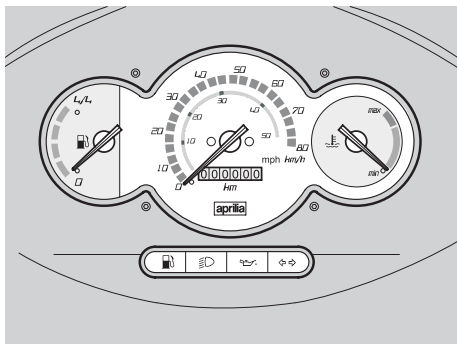

CHANGING THE DASHBOARD BULBS

Carefully read p. 59 (BULBS).

The dashboard contains:

- ◆ The warning light bulbs;
- ◆ The dashboard lighting bulbs;

To change the bulbs:

 To replace the two bulbs that light up the upper part of the dashboard it is sufficient to remove the front handlebar cover, see p. 50 (REMOVING THE FRONT HANDLEBAR COVER).

- ◆ Remove the rear handlebar cover, see p. 50 (REMOVING THE REAR HANDLEBAR COVER).

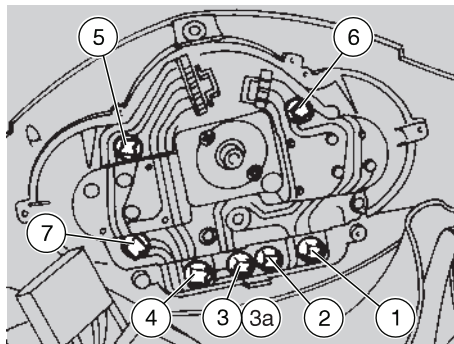

WARNING LIGHT BULBS



Extract the bulb sockets one by one, in such a way as to avoid positioning them incorrectly during the reassembly.

- ◆ Extract the relative bulb socket:

Pos.	Warning light	Colour
1	Direction indicators (↔)	green
2	2 stroke oil reserve (⚙)	red
3	Low beam (ℓ)	green
4	Low fuel (⛽)	amber

- ◆ Extract the bulb and replace it with one of the same type.

DASHBOARD LIGHTING BULBS



Extract the bulb sockets one by one, in such a way as to avoid positioning them incorrectly during the reassembly.

- ◆ Extract the bulb socket of the dashboard part in which there has been a light decrease:

Pos.	Lit part
5	upper right part
6	upper left part
7	lower right part

- ◆ Extract the bulb and replace it with one of the same type.

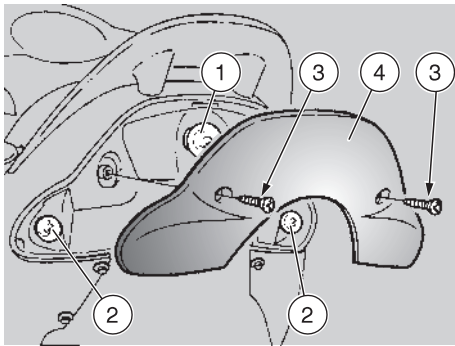

CHANGING THE REAR LIGHT BULB

Carefully read p. 59 (BULBS).

The rear light contains:

- ◆ A parking light/stoptight bulb (1).
- ◆ Two rear direction indicator bulbs (2).

To change them:

- ◆ Unscrew and remove the screws (3).

 While removing the protection screen, proceed carefully in order not to break the cog.

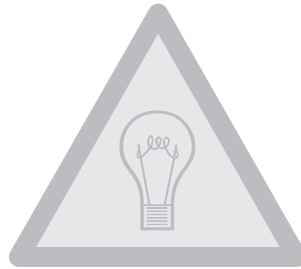

- ◆ Remove the protection screen (4).
- ◆ Slightly press the bulb and rotate it anti-clockwise.
- ◆ Remove the bulb from its seat.

 Insert the bulb in the socket, making the two bulb pins coincide with the relevant guides on the socket.

- ◆ Correctly install a new bulb of the same type.

 Upon reassembly, correctly position the protection screen in its seat.

Tighten the screw (3) carefully, without exerting too much pressure, in order to avoid damaging the protection screen.

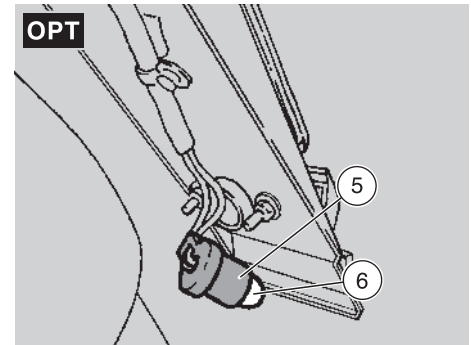

CHANGING THE NUMBER PLATE BULB OPT

Carefully read p. 59 (BULBS).

To change the bulb:

 Do not pull the electric wires to extract the bulb socket.

- ◆ Grasp the bulb socket (5) from the inside of the rear part of the fairing cover, pull it and remove it from its seat.
- ◆ Withdraw the bulb (6) and replace it with a new one of the same type.



 Before transporting the vehicle, it is necessary to empty the fuel tank and the carburettor completely, making sure that both are completely dry. During transport, the vehicle must be held upright, in its normal use position, to avoid any oil and battery fluid leakage.

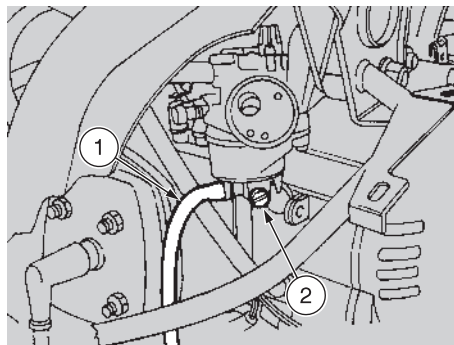

DRAINING THE FUEL TANK

Carefully read p. 21 (FUEL).



Risk of fire.
Wait until the engine and the exhaust silencers have completely cooled down.



Fuel vapours are noxious for your health.
Before proceeding, make sure that the room in which you are working is properly ventilated.
Do not inhale fuel vapours.
Do not smoke, nor use free flames.
Do not dispose of fuel in the environment.

- ◆ Position the vehicle on the centre stand.
- ◆ Stop the engine and wait until it has cooled down.
- ◆ Prepare a container with capacity exceeding the fuel quantity present in the tank and put it on the ground on the left side of the vehicle.
- ◆ Empty the fuel tank by means of a manual pump or a similar system.



After draining the tank, tighten the plug.

To empty the carburettor completely, proceed as follows:

- ◆ Remove the filter casing, see p. 38 (AIR CLEANER).
- ◆ Put the free end of the pipe (1) into a receptacle.
- ◆ Open the carburettor outlet by loosening the drain screw (2) positioned under the float chamber.

When all the fuel has flowed out of the carburettor:

- ◆ Tighten the drain screw (2) completely.



Tighten the drain screw (2) with care, to avoid fuel leakages from the carburettor during the refuelling.



Clean the vehicle frequently if it used in particular areas or conditions, such as:

- ◆ Polluted areas (cities and industrial areas).
- ◆ Areas characterized by a high percentage of salinity and humidity (sea areas, hot and humid climates).
- ◆ Particular conditions (use of salt and anti-ice chemical products on the roads during the winter).
- ◆ Avoid leaving deposits of industrial and polluting powders, tar spots, dead insects, bird droppings, etc. on the body.
- ◆ Avoid parking the vehicle under trees, since in some seasons residues, resins, fruits or leaves fall down, which contain substances that may damage the paint.



After the vehicle has been washed, its braking functions could be temporarily impaired because of the presence of water on the grip surfaces. Calculate long braking distances to avoid accidents. Brake repeatedly to restore normal conditions.

Carry out the preliminary checking operations, see p. 29 (PRELIMINARY CHECKING OPERATIONS).

To remove dirt and mud from the painted surfaces use a low- pressure water jet; carefully wet the dirty parts, remove mud and filth with a soft car sponge impregnated with a lot of water and shampoo (2÷4% parts of shampoo in water). Then rinse with plenty of water and dry with chamois leather.

To clean the outer parts of the engine use a degreaser, brushes and wipers.



Polish with silicone wax only after having carefully washed the vehicle.

Do not wash the vehicle under the sun, especially during the summer, when the body is still warm, since if the shampoo dries before being rinsed away, it can damage the paint.

Do not use polishing pastes on matt paints.

Do not use water (or liquids) at a temperature exceeding 40°C to clean the plastic components of the vehicle.

Use neither high pressure water/air jets, nor vapour jets on the following parts: wheel hubs, controls on the right and on the left side of the handlebars, bearings, carburettor, brake pump, instruments and indicators, silencer exhaust, glove compartment, ignition switch/steering lock.

Do not use alcohol, petrol or solvents to clean the rubber and plastic parts and the saddle: use only water and mild soap.



Do not apply protection waxes onto the saddle, in order not to make it too slippery.



LONG PERIODS OF INACTIVITY

After a long period of inactivity of the vehicle some precautions are necessary to avoid any problem.

Further, it is important to carry out the necessary repairs and a general check up before the period of inactivity, since you could forget to carry them out later.

Proceed as follows:

- ◆ Empty the fuel tank and the carburettor, see p. 64 (DRAINING THE FUEL TANK).
- ◆ Extract the spark plug and pour a teaspoon (5-10 cm³) of two-stroke engine oil into the cylinder.
Move the ignition switch to position “○”, press the start push button “Ⓢ” for a few seconds, to distribute the oil evenly on the cylinder surfaces.
Put back the spark plug.

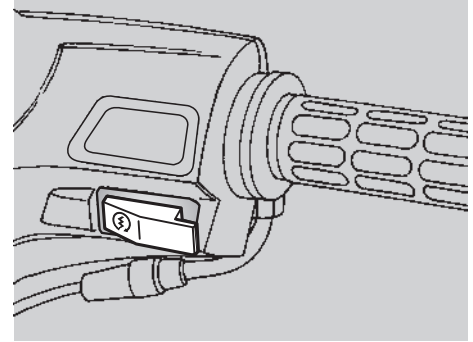
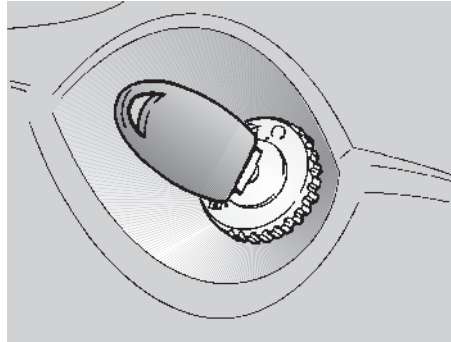

- ◆ Remove the battery, see p. 56 (REMOVING THE BATTERY).
- ◆ Wash and dry the vehicle, see p. 65 (CLEANING).
- ◆ Polish the painted surfaces with wax.
- ◆ Inflate the tyres, see p. 25 (TYRES).
- ◆ By means of a suitable support, position the vehicle so that both tyres are raised from the ground.
- ◆ Place the vehicle in an unheated, not-humid room, away from sunlight, with minimum temperature variations.
- ◆ Cover the vehicle avoiding the use of plastic or waterproof materials.



AFTER A PERIOD OF INACTIVITY

- ◆ Uncover and clean the vehicle, see p. 65 (CLEANING).
- ◆ Check the electrolyte level in the battery and install it, see p. 57 (CHECKING THE ELECTROLYTE LEVEL) and p. 57 (INSTALLING THE BATTERY).
- ◆ Make sure that the fuel drain screw is thoroughly screwed (breather pipe closing index), see p. 64 (DRAINING THE FUEL TANK).
- ◆ Refuel, see p. 21 (FUEL).
- ◆ Carry out the preliminary checking operations, see p. 29 (PRELIMINARY CHECKING OPERATIONS).



Have a test ride at moderate speed in a low-traffic area.

TECHNICAL DATA

DIMENSIONS	Max. length	1680 mm
	Max. width.....	680 mm
	Max. height (front part of the fairing included)	1070 mm
	Seat height.....	795 mm
	Distance between centres.....	1180 mm
	Min. ground clearance	155 mm
	Weight ready for starting.....	80 kg
	Weight ready for starting 	87 kg
ENGINE	Type	MINARELLI, 2-stroke with controlled ignition
	Number of cylinders	1
	Total displacement.....	49.26 cm ³
	Bore/stroke.....	40 mm / 39.2 mm
	Compression ratio.....	12.5 ± 0.5:1
	Starting.....	electric + kick starter
	Clutch.....	centrifugal
	Change gear	automatic stepless variator
Cooling.....	with forced air	
Cooling 	liquid cooled	



CAPACITY	Fuel (reserve included).....	8 ℓ
	Fuel reserve.....	1,5 ℓ
	Transmission oil.....	100 cm ³
	Mixer oil (reserve included)	1.6 ℓ
	Mixer oil reserve	0.5 ℓ
	Coolant 	1 ℓ(50% antifreeze + 50% water)
	Seats	1 (2 in the countries where this is allowed)
	Vehicle max. load (driver + luggage)	105 kg
	(driver+passenger+luggage)	180 kg (in the countries where this is allowed)
TRANSMISSION	Speed change gear	automatic and stepless
	Primary	V-belt
	Ratios	minimum for stepless change: 2.6 maximum for stepless change: 0.862
	Secondary	with gears
CARBURETTOR	Model:	
	– standard.....	DELL'ORTO PHBN 12
	– alternative	TEI KEI TK 3AA
	Choke tube	Ø12 mm
FUEL SUPPLY	Fuel	unleaded petrol according to the DIN 51607 standard, min. O.N. 95 (N.O.R.M.) and 85 (N.O.M.M.)

FRAME	Type	one-beam, split in two cradles
SUSPENSIONS	Front.....	hydraulically operated telescopic fork
	Stroke.....	65 mm
	Rear	hydraulic mono-shock absorber
	Stroke.....	70 mm
BRAKES	Front.....	disc brake, Ø155 mm with hydraulic transmission
	Rear	drum brake, Ø110 mm, with mechanic transmission
WHEELS	RIMS	alloy
	Front.....	2.50 x 10"
	Rear	2.50 x 10"
	TYRES	tubeless
	Front.....	100/90 - 10" - 56J
	Rear	100/90 - 10" - 56J
STANDARD INFLATION PRESSURE		
	Front.....	170 kPa (1.7 bar)
	Rear	190 kPa (1.9 bar)
INFLATION PRESSURE WITH PASSENGER (where drive with passenger is allowed)		
	Front.....	170 kPa (1.7 bar)
	Rear	210 kPa (2.1 bar)

IGNITION	Type.....	CDI
	Spark advance.....	14° ± 2° before T.D.C.
	Standard spark plug	NGK BR8 HS
	Standard spark plug 	NGK BR8 HS
	Spark plug gap	0.5 ÷ 0.6 mm
	Engine idle rpm.....	1800 ± 100 rpm

ELECTRIC SYSTEM	Battery	12 V - 4 Ah
	Fuse.....	7.5 A
	Generator (with permanent magnet)	12 V - 85 W
	Low beam bulbs	12 V - 15 W
	Direction indicator bulbs	12 V - 10 W
	Rear parking light/stoptlight bulb	12 V - 5/21 W
	Number plate bulb OPT	12 V - 3 W
	Dashboard bulbs	12 V - 1.2 W
	Low beam warning light.....	12 V - 1.2 W
	Direction indicators warning light.....	12 V - 2 W
2 stroke oil reserve warning light.....	12 V - 2 W	
Low fuel warning light.....	12 V - 1.2 W	

LUBRICANT CHART

Transmission oil (recommended):  F.C., SAE 75W - 90 or  Agip GEAR SYNTH, SAE 75W - 90.





As an alternative to the recommended oil, it is possible to use high-quality oils with characteristics in compliance with or superior to the A.P.I. GL-4 specifications.

Mixer oil (recommended):  GREEN HIT 2 or  Agip CITY 2T.

As an alternative to the recommended oil, use high-quality oils with characteristics in compliance with or superior to the ISO-L-ETC++, A.P.I. TC++ specifications.

Fork oil (recommended):  F.A. 5W or  F.A. 20W fork oil;

an alternative  Agip FORK 5W or  Agip FORK 20W fork oil.

If you need an oil with intermediate characteristics in comparison with the  F.A. 5W and  F.A. 20W or  Agip FORK 5W and  Agip FORK 20W, these can be mixed as indicated below:

SAE 10W =  F.A. 5W 67% of the volume +  F.A. 20W 33% of the volume, or
 Agip FORK 5W 67% of the volume +  Agip FORK 20W 33% of the volume;

SAE 15W =  F.A. 5W 33% of the volume +  F.A. 20W 67% of the volume, or
 Agip FORK 5W 33% of the volume +  Agip FORK 20W 67% of the volume.

Bearings and other lubrication points (recommended):  AUTOGREASE MP or  Agip GREASE 30.

As an alternative to the recommended product, use high-quality grease for rolling bearings, working temperature range -30°C.... +140°C, dripping point 150°C... 230°C, high protection against corrosion, good resistance to water and oxidation.

Protection of the battery poles: neutral grease or vaseline.

WARNING

Use new brake fluid only.

Brake fluid (recommended):  F.F., DOT 5 (DOT 4 compatible) or  Agip BRAKE 5.1, DOT 5 (DOT 4 compatible).

WARNING

Use only antifreeze and anticorrosive without nitrite, ensuring protection at -35°C at least.

Engine coolant (recommended):  ECOBLU - 40°C or  Agip COOL.

NOTE

aprilia

ASK FOR GENUINE SPARE PARTS ONLY

NOTE

aprilia

ASK FOR GENUINE SPARE PARTS ONLY

- 
- I** APRILIA s.p.a. via G. Galilei, 1 - 30033 Noale (VE) Italy
Tel. +39(0)41 5829111 - Fax +39(0)41 441054 - Servizio Clienti **aprilia** +39(0)41 5786269
 - F** APRILIA WORLD SERVICE B.V. Z.A. Central Parc - 255 BLD Robert Ballanger
B.P. 77- 93421 Villepinte (F) - Tel. (0) 149634747 - Fax (0) 149638750
 - D** MOTORRAD GmbH Am Seestern 3 D-40547 Düsseldorf (D)
Tel. (211) 59018-00 - Fax (211) 5901819
 - E** APRILIA WORLD SERVICE B.V. ESPAÑA Avda. de Aragón, 334 - Edificio América - 28022 - Madrid (E)
Tel. 91 7460066 - Fax 91 7460062
 - NL** APRILIA NEDERLAND Nikkelstraat 1 - 4823 AE Breda (NL)
Tel. (076) 5431640 - Fax (076) 5431649
 - UK** APRILIA MOTO U.K. LTD. Dunragit - Stranraer - Wigtownshire DG9 8PN - Scotland (UK)
Tel. (01776) 888670 - Fax (01581) 400661 - E-mail: aprilia@aol.com
 - USA** APRILIA USA Inc. 110 Londonderry Court, Suite 130 - Woodstock, GA 30188 (USA)
Tel. 770 592 2261 - Fax 770 592 4878
 - A** GINZINGER IMPORT GmbH & CO Frankfurterstrasse 19 - 4910 Ried im Innkreis (A)
Tel. (7752) 88077 - Fax (7752) 70684 - E-mail: elke.ginzinger@ivnet.co.at
 - P** MILFA IMPORTAÇÃO EXPORTAÇÃO LDA. Avenida da Republica 692 - 4450-238 Matosinhos (P)
Tel. 229382450 - Fax 229371305 - E-mail: milfa@meganet.pt
 - SF** TUONTI NAKKILA OY P.o.B. 18 - 29250 Nakkila (SF)
Puh. (02) 5352500 - Fax (02) 5372793 - E-mail: varaosat@npm.fi
 - B** RAD n.v. / s.a. Industriegebiet - Landegemstraat 4 - B - 9031 Drongen-Baarle
Tel. (09) 2829410 - Fax (09) 2829433 - E-mail: aprilia@rad.be
 - GR** MOBILITY S.A. Lahana 12 N. Filadelfia - 143 42 Athens (GR)
Tel. (1) 2723552 - Fax (1) 271478 - E-mail: mobility@internet.gr
 - GR** MOBILITY A.E. Λαααα 12 Ν. Φιλαδέλφια - 143 42 Αθήνα - Ελλάδα
Τηλ. (1) 2723552 - Φαξ (1) 271478 - E-mail: mobility@internet.gr
 - CH** MOHAG AG Bernerstrasse Nord 202 - 8064 Zurich (CH)
Tel. (1) 4348686 - Fax (1) 4348606 - E-mail: info@mohag.ch
 - DK** **S** T.M.P. Islandsvej 3 - 7900 Nykøbing Mors (DK)
Tel 97722233 - Fax 97722133 - E-mail: t_m_p@post4.tele.dk
 - J** BOSCO MOTO CO. LTD. 22-25 Hakunoshima 2 Chome Minoo-Shi 562 Osaka
562-0012 OSAKA (J) - Tel. (0727) 253311 - Fax (0727) 253322
 - J** 株式会社 ボスコ・モト 〒 562-0012 大阪府箕面市白鳥 2 丁目 22-25
電話：(0727)25-3311 - FAX：(0727)25 3322
 - SGP** IDEAL MOTOR SPORT PTE. LTD. 20 Mactaggart Road, #01-01 Khong Guan Industrial Building 368079 Singapore (SGP)
Tel. 2820082 - Fax 2821012 - E-mail: idealmtr@mbox4.singnet.com.sg
 - H** MILLE MOTOR KFT. H-1054 - Budapest - Hold u. 23. (H)
Tel. +36 1 301 0021 - Fax +36 1 301 0021 - E-mail: aprilia@apriliamotor.hu

PL MOTO SP. ZOO
Ul. Trakt Lubelski 298 B - 04-667 Warszawa (PL)
Tel. (22) 121183 - Fax (22) 121183

IL METRO MOTOR MARKETING LTD.
12, Tushia Street - P.O. BOX 57266 - 61572 - Israel - Tel-Aviv (IL)
Tel. (3) 5623951 - Fax (3) 5623950 - E-mail: metro@inter.net.il

ROK BIKE KOREA CO., LTD.
YeungSoo BLDG 302 #206-25, Ohjang-dong, Chung-ku, Seoul (ROK)
Tel. (02) 2275-6130/1 - Fax. (02) 2275-6132 - E-mail: kukbike@yahoo.co.kr

MAL GENTALI MALAYSIA SDN BHD
Unit B-1-8 Megan Phileo Promenade 189 Jalan Tun Razak - 50400 - Kuala Lumpur (MAL)
Tel.(603) 21649800 - Fax. (603) 21649700

RCH HARLEY DAVIDSON SANTIAGO
Isidora Goyenechea 2926 - Santiago (RCH)
Tel. (2) 2321667 - Fax (2) 2321894

BM EVE'S CYCLES LTD.
114, Middle Road - PG BX, Paget (BM)
Tel. (441) 2366247 - Fax (441) 2366996

BR APRILIA-BRASIL
Av. Europa, 352 - Jardim Europa - 01449-001 Sao Paulo-SP (BR)
Tel. (11) 30691220 - Fax. (11) 30691221 - E-mail: hjdeki@aprilia.com.br

AUS JOHN SAMPLE GROUP PTY LTD.
8, Sheridan Close - NSW 2214 - Milperra - Sydney (AUS)
Tel. (2) 97722666 - Fax (2) 97742321 - E-mail: jcaruso@jsg.com.au

RSA MOTOVELO S.A.
Old Pretoria Road - Wynberg - Johannesburg (RSA)
Tel. (11) 7868486 - Fax (11) 7868482 - E-mail: motovelo@betech.co.za

NZ MOTORCYCLING DOWNUNDER LTD.
35, Manchester Street - P.o.B. 22416 - Christchurch (NZ)
Tel. (3) 3660129 - Fax (3) 3667580 - E-mail: guzzi@motorcycling-nz.co.nz

HR ING-KART, d.o.o.
Miroslava Magdalenica, 1 - 10000 Zagreb (HR)
Tel. (1) 3491107 / 3491091 - Fax (1) 3491555 - E-mail: ing-kart@zg.tel.hr

SLO AVTO TRIGLAV, d.o.o.
Baragova 5 - 1113 Ljubljana (SLO)
Tel. (61) 1883420 - Fax (61) 1883465 - E-mail: ziga.martincic@avto-triglav.si

M BIKES & COMPANY LTD.
178, Marina Street, Pieta. MSD 08. (M) - Tel. (+356) 236 665 - Fax (+356) 239 368

TR METRO MOTORLU ARACLAR TICARET A.S.
Mihrabat Caddesi Akbeysokak Yetimoglu Is Merkezi -
81640 - Kavacik-Istanbul (TR) - Tel. (0216) 4251565 - Fax (0216) 3312606

CZ A. SPIRIT a.s.
Sluzeb 5 - 10800 Praha 10 (CZ)
Tel. +420-2-72703049 - Fax. +420-2-72702156 - E-mail: office@aspirit.cz

IRL K.D.I. KAWASAKI DISTRIBUTOR IRL. LTD.
17 Wood Street - Dublin 8 (IRL)
Tel. (1) 4756046 - Fax. (1) 4756461

N HARO SKANDINAVIA A.S.
Kjorbekkdalen 6 - 3735 - Skien, Norway (N)
Tel. 35506780 - Fax. 35506781 - E-mail: post@aprilia.no

MEX APRILIA DE MEXICO, SA. de CV.
San Jeromino - 64640 - 552 Monterrey N.L. (MEX)
Tel. 8333-4493 - Fax. 8348-9398 - E-mail: javier@aprilia.com.mx

WIRING DIAGRAM Sonic 50

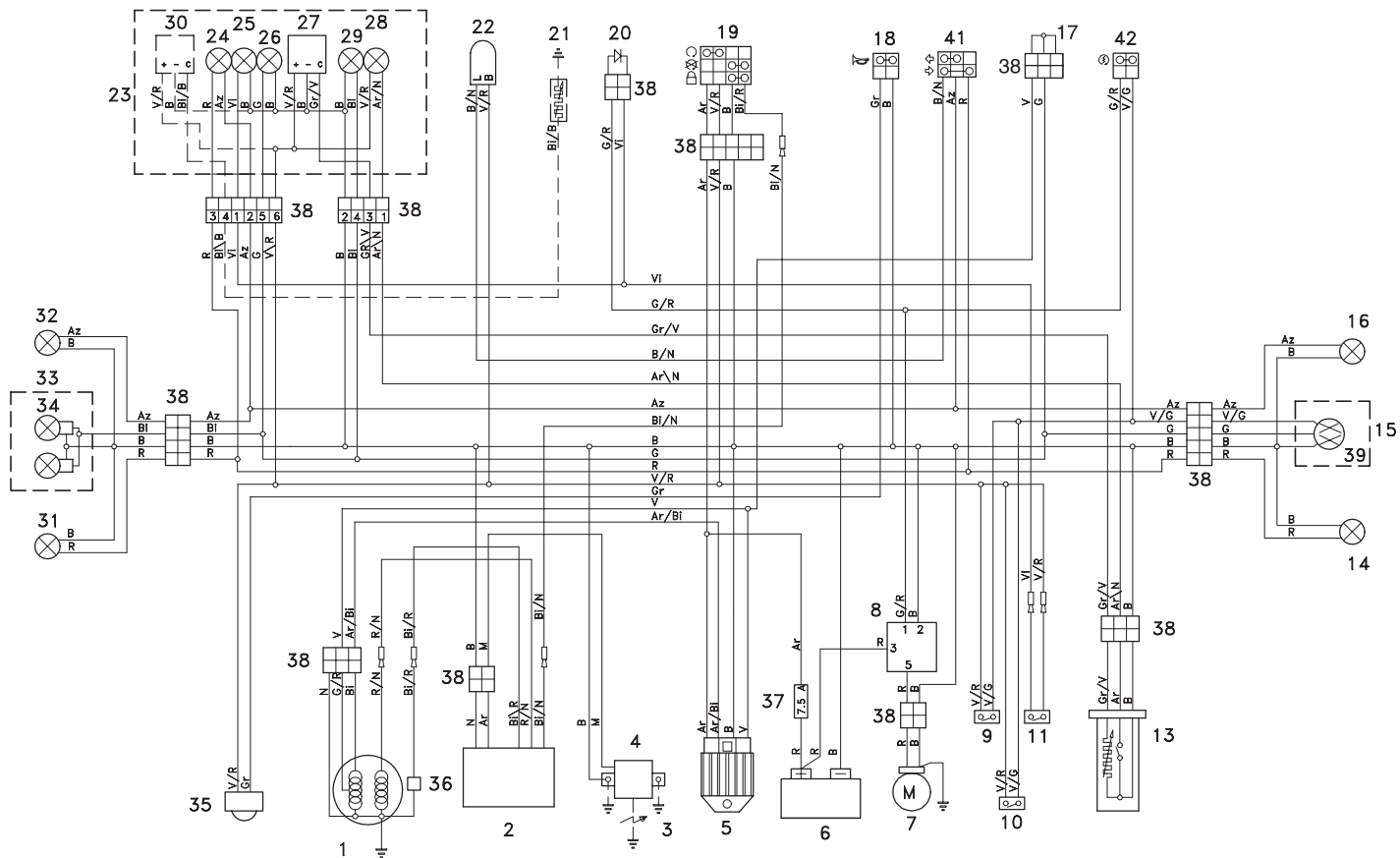

WIRING DIAGRAM KEY Sonic 50

- 1) Generator
- 2) CDI
- 3) Spark plug
- 4) HT coil
- 5) Voltage regulator
- 6) Battery
- 7) Starter
- 8) Start relay
- 9) Front stoplight switch
- 10) Rear stoplight switch
- 11) 2 stroke oil reserve switch
- 13 Fuel level sensor
- 14) Rear right direction indicator
- 15) Rear light
- 16) Rear left direction indicator
- 17) Bridge
- 18) Horn push button
- 19) Ignition switch/steering lock
- 20) Control diode
- 21) Coolant thermistor 
- 22) Blinking
- 23) Dashboard
- 24) Direction indicator warning light
- 25) 2 stroke oil reserve warning light
- 26) Dashboard light
- 27) Fuel level instrument
- 28) Low fuel warning light
- 29) Low beam warning light

- 30) Coolant temperature instrument 
- 31) Front right direction indicator
- 32) Front left direction indicator
- 33) Front parking light
- 34) Low beam bulb
- 35) Horn
- 36) Pick up
- 37) Fuse
- 38) Multiple connectors
- 39) Rear parking light/stoplight
- 41) Direction indicator switch
- 42) Start push button

CABLE COLOURS

- Ar** Orange
Az Light blue
B Blue
Bi White
G Yellow
Gr Grey
M Brown
N Black
R Red
V Green
Vi Violet

NOTE

aprilia

ASK FOR GENUINE SPARE PARTS ONLY

NOTE

aprilia

ASK FOR GENUINE SPARE PARTS ONLY

aprilia s.p.a. wishes to thank its customers for the purchase of this vehicle.

- Do not dispose of oil, fuel, polluting substances and components in the environment.
- Do not keep the engine running if it isn't necessary.
- Avoid disturbing noises.
- Respect nature.